



全球拉索定制专家

*Custom
Cable Expert*



www.dgshuanghe.com
www.dgshc.com



东莞市双和机车拉索有限公司
DONGGUAN SUMHO CONTROL CABLE CO., LTD

地址: 中国广东省东莞市横沥镇三江工业区142号
电话: +86-769-81017575
传真: +86-769-81017595
邮箱: sumho@dgshc.com
邮编: 523460

Add: NO.142, Sanjiang Industrial Zone, Hengli Town,
Dongguan City, Guangdong, China
Tel: +86-769-83390345
Fax: +86-769-81017595
E-mail: sumho@dgshc.com
ZIP: 523460



☎ 4008 839 849

东莞市双和机车拉索有限公司
DONGGUAN SUMHO CONTROL CABLE CO., LTD

ABOUT US 关于双和

东莞市双和机车拉索有限公司是一家专业定制各类拉索的生产厂家, 经过二十多年的发展, 在国内拉索行业中处于领先地位。

丰富的行业经验让我们能根据客户的需求, 提供更合理的拉索使用方案, 保证使用品质的同时, 既能满足客户需求, 又能降低成本。

我们的努力赢得了广大客户的信赖和支持, 目前与国内外多家知名企业建立了良好的配套合作关系, 如丰田、赫曼米勒、美标、富世华、创科集团等全球知名品牌。产品主要销往美国、日本、德国、英国等国家。

Dongguan SUMHO Control Cable Co.,Ltd is a professional cable factory. After 20 years development, we have been a leading cable factory in China.

Based on rich experience in cable industry, we can supply more reasonable cable solutions for our customers. It will meet or exceed our customers' requirement and reduce the cost.

Our profession helped us to gain the trust and support from many outstanding companies, such as TOYOTA, Herman Miller, American Standard, Husqvarna, TTI. Most of our products are exported to USA, Japan, Germany etc.



全球领先 服务一流品牌

First-Class Products For First-Class Brands





Our Wish 双和愿景:

成为具有国际影响力的拉索企业

To be an international-influence cable Manufacturer in the world

Our Growth 开发纪实:

时间 Time	服务行业 Service industry	客户代表 Main Customer
2014	汽车 Automobile	服务标致汽车 Service for PEUGEO cars
2013	汽车 Automobile	服务奔驰汽车 Service for Mercedes-Benz
2010	家具 Furniture	服务于全球办公家具著名品牌-赫曼米勒 To be the supplier of famous office furniture brand-HermanMiller
2009	汽车 Automobile	服务丰田汽车 Service for TOYOTA cars.
2005	卫浴洁具 Sanitary equipment	服务全球著名卫浴品牌美标公司 Service for the famous sanitary brand-American Standard.
2004	园林机械 Garden machinery	成为全球著名电动工具集团-TTI公司的供应商 To be the supplier of famous power tools group-TTI
2002	园林机械 Garden machinery	服务全球著名户外设备集团-富世华公司 Service for famous outdoor equipment brand-Husqvarna
2000	健身器材 Fitness equipment	服务于全球知名健身器材品牌-美国爱康 Service for the famous fitness equipment brand- ICON
1993	摩托车 Motorcycle	服务于本田系列、铃木系列客户 Service for HONDA, SUZUKI series

4008 839 849
www.dgshc.com

The R&D Team

富有研发创造力的研发团队

- ☑ 经验丰富的研发团队能设计出结构更合理的拉索使用方案，既实用又能满足客户需求。
Experienced R&D team could provide more reasonable cable solutions & reduce the cost.
- ☑ 我们的专业工程师会提供定制ProE, Solidworks ,CAD等图纸给客户选择，多年的实践证明：很多方案一经被采用，后来被行业标准化生产运用。
Our professional engineers will provide latest Pro-E,Solidworks,CAD drawing for choosing. Many solutions once specially designed, are standard today.
- ☑ 通过FMEA分析，我们能选择最佳的材料和最优异成本来适应于不同的需求，让客户得到实际利益。
By FMEA analysis,we can choose the best material and the most economical cost for different requirements and our customer can get the real benefits from that.

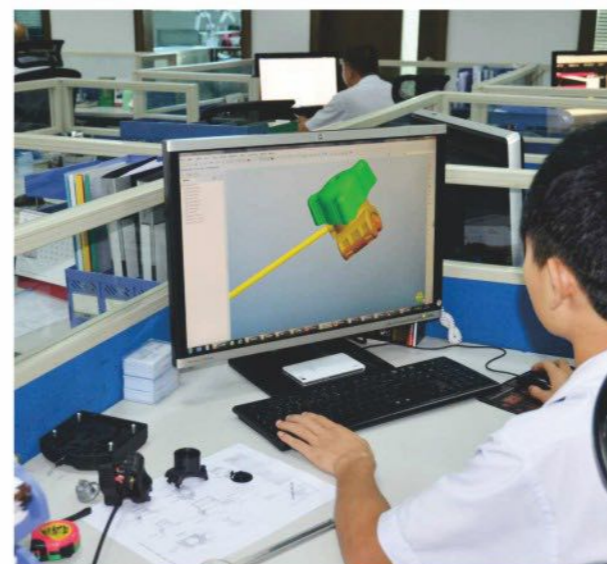

The Quality Control 品质控制



- ☑ 原料科学检验，作业流程专人管控，在岗人员专业技能培训来保证双和拉索品质做得更好。
Check the raw material by special machines. Control production flow by experienced workers. Provide the professional training for our workers to ensure the product quality.
- ☑ 模拟产品进行仿真寿命测试，探知潜在问题并及时完善。
Do useful time test for our new products to get the potential problem and solved on time.
- ☑ 所有制作过程通过工艺控制，设备监控来确保品质的稳定性。
Technical control in production process to keep the stability of the quality.

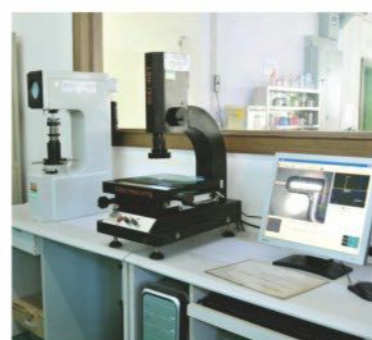

Production Ability 生产实力



- ☑ 十五条生产线，满足客户需求。
Fifteen production lines, To meet the needs of customers.
- ☑ 定制设备，自动化生产，降低生产成本。
Custom equipment, Automatic production, Reduce production cost.
- ☑ 全员改善，没有最好，只有更好。
Overall improvement, No best, But better.



Contents

产品目录

钢丝绳
Wire Rope page 09



套管
Conduit page 12



压铸端子
Die Casting Ends page 15



铆接端子
Riveting Fittings page 20



R形锻造端子
Paddle Fittings page 21



铝套
Aluminum Sleeves page 22



U形端子
U Forks page 23



葫芦钩
Hooks page 24



夹头
Clamps page 25



单向锁线器
Wire Locked Clips page 26



吊灯固定底座
Lighting Fixed Bases page 27



套管帽
End Caps page 28



套管帽
End Caps page 29



螺栓
Screws page 30



塑胶/金属卡头
Plastic/Metal Clips page 31



塑胶侧卡帽/直卡帽
Side/Straight Clips page 32



四方帽/C形卡座
Square Ends & "C" Blocks page 33



弯管/防尘帽/弹簧
Bend Tubes & Protect Caps & Springs page 34



调节螺栓组件
Adjusting Screw Assembly page 35



连接体
Connectors page 36



座椅底盘控制拉索
Cables For Chair Chassis page 37



开关拉索组件
Motion Furniture Cable Assembly page 39



座椅腰靠调节器组件
Seat backrest adjustment assembly page 41



无极微调组件
Tension Control page 44



八段旋钮组件
Eight Scale Tension Control page 46



割草机油门线
Throttle Cables page 49



草坪机拉索
Control Cable For Garden Machine page 52



冲压支座油门线
Throttle Cables page 53



变档开关线
Throttle Cables page 56



换档开关线
Shift Cable page 57



推拉索
Push Pull Cables page 58



汽车拉索
Automobile Cables page 59



座椅拉索
Seat Cables page 61



园林机械拉索
Outdoor Power Equipment Cables page 63



卫浴洁具拉索
Sanitary Equipment Cables page 65



童车拉索
Pram Cables page 67



其他拉索\软轴
Other Cables & Flexible Shaft page 69



钢索
Steel Cables page 71



精密五金配件
Hardware & Rubber Accessories page 73



产品选型指引
Product Selection Guidelines page 74



钢丝绳 Wire Rope



镀锌钢丝绳/不锈钢钢丝绳 Galvanized or stainless steel wire rope

■ 材质：镀锌/不锈钢
结构：单层钢丝

■ Materials: Galvanized / Stainless steel
Construction: Single

外径 Dia mm	钢丝绳材质 Wire Rope Material	参考重量 Approx. Weight Kg/100m	项目编号 Item No.
0.6	Stainless	0.17	W1106
1.2	Galvanized	0.83	W1112
1.3	Stainless	0.98	W1113
1.4	Galvanized	1.18	W1114
1.6	Galvanized/stainless	1.56	W1115
1.8	Stainless	1.97	W1118
2.0	Stainless	2.20	W1120

■ 材质：镀锌/不锈钢
结构：1X7

■ Materials: Galvanized / Stainless steel
Construction: 1X7

外径 Dia mm	最小破断强度 Min. break Strength(kgf)		参考重量 Approx. Weight Kg/100m	项目编号 Item No.
	Galvanized	Stainless		
0.5	29	27	0.13	W1705
0.8	72	68	0.32	W1708
1.0	110	105	0.50	W1710
1.2	155	150	0.74	W1712
1.5	240	230	1.15	W1715
1.8	340	330	1.63	W1718
2.0	420	410	2.05	W1720

■ 材质：镀锌/不锈钢
结构：1X19

■ Materials: Galvanized / Stainless steel
Construction: 1X19

外径 Dia mm	最小破断强度 Min. break Strength(kgf)		参考重量 Approx. Weight Kg/100m	项目编号 Item No.
	Galvanized	Stainless		
0.8	70	60	0.32	W1908
1.0	105	95	0.50	W1910
1.2	150	140	0.72	W1912
1.5	250	215	1.12	W1915
1.8	340	310	1.61	W1918
2.0	425	365	2.00	W1920
2.5	665	570	3.10	W1925
3.0	850	730	4.48	W1930
3.5	1100	950	6.00	W1935
4.0	1400	1200	7.90	W1940
5.0	2180	1880	12.50	W1950
6.0	3150	2700	18.10	W1960

■ 材质：镀锌/不锈钢
结构：1X37

■ Materials: Galvanized / Stainless steel
Construction: 1X37

外径 Dia mm	最小破断强度 Min. break Strength(kgf)		参考重量 Approx. Weight Kg/100m	项目编号 Item No.
	Galvanized	Stainless		
2.5	580	555	3.05	W3725
3.0	830	800	4.39	W3730
3.5	1130	1090	5.99	W3735
4.0	1480	1420	7.82	W3740
4.8	2130	2050	11.30	W3748
5.0	2300	2110	12.20	W3750
6.0	3330	3000	17.60	W3760

■ 材质：镀锌/不锈钢
结构：7X7

■ Materials: Galvanized / Stainless steel
Construction: 7X7

外径 Dia mm	最小破断强度 Min. break Strength(kgf)		参考重量 Approx. Weight Kg/100m	项目编号 Item No.
	Galvanized	Stainless		
0.5	NA	20	0.10	W7705
0.6	NA	25	0.14	W7706
0.7	NA	35	0.20	W7707
0.8	NA	49	0.27	W7708
1.0	85	75	0.42	W7710
1.2	120	108	0.61	W7712
1.5	180	170	0.95	W7715
1.8	260	245	1.34	W7718
2.0	310	290	1.65	W7720
2.5	480	460	2.57	W7725
3.0	700	660	3.71	W7730
3.18	780	740	4.17	W7732
3.5	920	900	5.05	W7735
4.00	1200	1150	6.60	W7740

■ 材质：镀锌/不锈钢
结构：7X19

■ Materials: Galvanized / Stainless steel
Construction: 7X19

外径 Dia mm	最小破断强度 Min. break Strength(kgf)		参考重量 Approx. Weight Kg/100m	项目编号 Item No.
	Galvanized	Stainless		
0.8	NA	45	0.27	W7908
1.0	NA	65	0.41	W7910
1.2	NA	98	0.59	W7912
1.5	200	160	0.95	W7915
2.0	360	280	1.68	W7920
2.5	560	435	2.63	W7925
3.0	810	625	3.78	W7930
3.5	1100	830	5.28	W7935
4.0	1275	1100	6.71	W7940
5.0	2100	1700	10.50	W7950
6.0	2950	2450	15.20	W7960
7.0	3900	2930	20.00	W7970
8.0	5000	4080	26.30	W7980

■ 材质：镀锌/不锈钢
结构：8X7+1X19

■ Materials: Galvanized / Stainless steel
Construction: 8X7+1X19

外径 Dia mm	最小破断强度 Min. break Strength(kgf)		参考重量 Approx. Weight Kg/100m	项目编号 Item No.
	Galvanized	Stainless		
1.5	200	NA	0.95	W8715

■ 弹簧钢丝绳
■ Spring Wire Rope

外径 Dia mm	螺旋外径 Spiral O.D Ref mm	结构 Construction	材料 Material	表面颜色 surface Color	项目编号 Item No.
1.0	13.5	7X7	Galvanized	-	W771014
1.5	28.0	7X7	Galvanized	-	W771528
1.5	27.0	7X7	Stainless	Natural color	W771527
2.0	40.0	7X7	Stainless	Natural color	W772040
2.4	18.0	7X7	Stainless	Natural color	W772418
2.8	47.0	7X7	Galvanized	Light blue	W772847
2.8	47.5	7X7	Galvanized	Blue	W772848
2.8	50.0	7X7	Galvanized	Red	W772850
6.0	55.0	"6X(3X7)+1X19"	Stainless	Natural color	W636055
6.0	68.0	"6X(3X7)+1X19"	Stainless	Natural color	W636068



包胶钢丝绳

Cable With Coating



■ 镀锌/不锈钢包胶钢丝绳
结构: 7X7
■ Galvanized or Stainless Steel Wire Rope
Constr.7x7, Plastic Coated

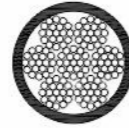

■ 镀锌/不锈钢包胶钢丝绳
结构: 7X19
■ Galvanized or Stainless Steel Wire Rope
Constr.7x19, Plastic Coated

钢丝外径 Wire Dia mm	外径 Coated Dia mm	最小破断强度 Min.break Strength(kgf)		涂层材料 Coated Material	项目编号 Item No.
		Galvanized	Stainless		
0.5	0.7	NA	20	PA	C770507
0.7	0.9	NA	38	PA	C770709
0.8	1	NA	49	PA	C770810
0.8	1.1	NA	49	PA	C770811
0.8	1.2	NA	49	PA	C770812
0.8	1.45	NA	49	PA	C770815
1	1.2	NA	75	PA	C771012
1	1.6	NA	75	PA	C771016
1.2	1.5	120	108	PA	C771215
1.2	1.6	NA	108	PA	C771216
1.2	1.7	NA	108	PVC	C771217
1.2	1.8	NA	108	PA	C771218
1.5	1.8	180	NA	PA	C771518
1.5	2	180	170	PA	C771520
1.5	2.5	NA	170	PVC	C771525
1.5	2.5	180	170	PA	C771525
1.5	2.5	180	NA	PU	C771525
1.6	2.4	NA	170	PA	C771624
1.8	2.5	220	NA	PVC	C771825
1.8	2.5	220	NA	PU	C771825
2	2.5	NA	290	PVC	C772025
2	2.5	310	NA	PA	C772025
2	3	310	NA	PU	C772030
2	3	310	NA	PVC	C772030
2.5	4	480	NA	PA/PU/PVC	C772540
3.2	4.8	780	NA	PVC	C773248
4	6	1200	NA	PVC	C774060

钢丝外径 Wire Dia mm	外径 Coated Dia mm	最小破断强度 Min.break Strength(kgf)		涂层材料 Coated Material	项目编号 Item No.
		Galvanized	Stainless		
1.0	1.2	NA	65	PA	C791012
1.2	1.6	NA	108	PA	C791216
2	3	NA	280	PU	C792030
3.2	4.8	920	NA	PU	C793248
4	6	1275	NA	PU	C794060
4.8	6.35	1900	NA	PVC/PA	C794864



■ 镀锌/不锈钢包胶钢丝绳
结构: 1X19
■ Galvanized or Stainless Steel Wire Rope
Constr.1x19, Plastic Coated

钢丝外径 Wire Dia mm	外径 Coated Dia mm	最小破断强度 Min.break Strength(kgf)		涂层材料 Coated Material	项目编号 Item No.
		Galvanized	Stainless		
1	1.6	105	95	PA	C191016
1.2	1.8	150	NA	PA	C191218
1.5	2.0	250	NA	PA	C191520
3.6	4.2	800	NA	PA	C193642



■ 镀锌/不锈钢包胶钢丝绳
结构: 1X37
■ Galvanized or Stainless Steel Wire Rope
Constr.1x37, Plastic Coated

钢丝外径 Wire Dia mm	外径 Coated Dia mm	最小破断强度 Min.break Strength(kgf)		涂层材料 Coated Material	项目编号 Item No.
		Galvanized	Stainless		
3.5	4.4	750	NA	PE	C373544

- ◆ 以上列出的为我司常用披覆钢丝绳;
- ◆ 适用于各种不同结构的钢丝绳, 所用披覆材质可为PA、PU、PVC等, 可以根据顾客需求来加工定制不同外径、不同披覆材料的产品。
- ◆ The above specifications are our usual coated wire specs.
- ◆ We can made custom coated wires for customer requirement with the material of PA,PU,PVC etc.

套管 Conduit



■ 单层胶管
■ Single-layer Conduit

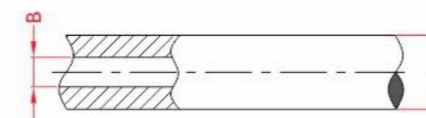

φA ±0.2mm	φB ±0.2mm	表面颜色 Surface Color	材质 Material	项目编号 Item No.
3.18	1.4	Black	PBT	C1-03214
3.18	1.57	Black	HDPE	C1-03216
4.0	1.7	Black	HDPE	C1-04017
4.18	1.9	Black	HDPE	C1-04219
5.0	2.1	Black / yellow / blue	PP	C1-05021
5.15	1.6	Black / Blue natural color	PP	C1-05216
7.1	4.06	Black	PE	C1-07141
8.06	4.37	Black	PE	C1-08144
9.65	5.59	Black	PE	C1-09756

■ 复合胶管
■ Two-layer Conduit

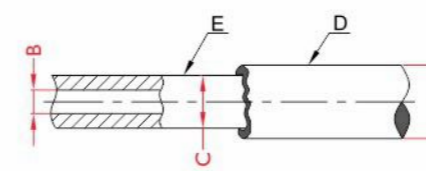

φA ±0.2mm	φB ±0.2mm	φC ±0.2mm	表面颜色 Surface Color	材质 Material		项目编号 Item No.
				D	E	
3.85	1.8	3.0	Black	PP	PBT	C2-03918
4.0	1.9	3.3	Black	PP	POM	C2-04019
5.0	1.7	3.6	Black/yellow Green/blue	PP	POM	C2-05017

- ◆ 主要用于卫浴洁具、汽车空调、园林机械油门线等拉索;
- ◆ 如果您需要其它规格的套管, 请联系我们技术顾问, 我们可以为您定制;
- ◆ Mainly used for Sanitary equipment, automotive air conditioning, garden machinery's throttle cable etc.
- ◆ It can be customized, if you want any other specs, please just feel free to contact us. Thanks.

■ 平行丝管
■ Double Wire Conduit

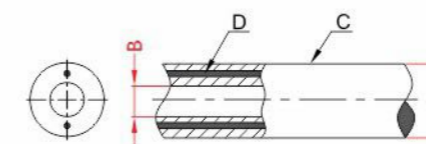

φA ±0.2mm	φB ±0.2mm	表面颜色 Surface Color	材质 Material		项目编号 Item No.
			C	D	
5.0	2.3	Black	PP	Steel wire	C3-05023
5.6	2.3	Black	PP	Steel wire	C3-05623

- ◆ 主要用于园林机械油门线等拉索。
- ◆ Mainly for throttle cable in Garden machines.

■ 扁织网管
■ Braided Conduit

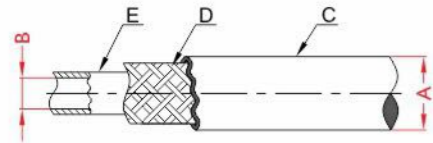

φA ±0.3mm	φB ±0.2mm	表面颜色 Surface Color	材质 Material			项目编号 Item No.
			C	D	E	
3.6	1.4	Black	PA	Steel wire	POM	C4-03614
4.36	1.6	Black	PP/PA	Steel wire	POM	C4-04416
5.0	1.9	Black	PP/PE	Steel wire	POM	C4-05019
13.2	8.0	Black	PU	Steel wire	PU	C4-13280
16.2	10.0	Black	PU	Steel wire	PU	C4-16210
18.6	12.0	Black	PU	Steel wire	PU	C4-18612

- ◆ 3.6~5.0套管主要用于座椅;
- ◆ 13.2~18.6套管主要用于保护软轴、传递、和定位等;
- ◆ 如果您需要其它规格的套管, 请联系我们技术顾问, 我们可以为您定制。
- ◆ φ3.6~φ5.0 Conduits mainly used for the Chair seat Cables.
- ◆ 13.2~18.6 Mainly used for protecting the flexible shaft, transfer and fixed position etc.
- ◆ It can be customized, if you want any other specs, please just feel free to contact us. Thanks.

■ 扁丝管(含内衬管)
■ Flat Wire Conduit(Include Inner Tube)

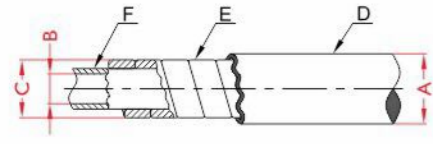

φA ±0.3mm	φB ±0.2mm	φC ±0.2mm	表面颜色 Surface Color	材质 Material			项目编号 Item No.
				D	E	F	
3.6	1.4	2.9	Black	PVC	Steel wire	PE	C5-03614
3.9	1.4	2.9	Black	PVC	Steel wire	PE	C5-03914
4.0	1.6	3.4	Black	PVC	Steel wire	PE	C5-04016
5.0	2.2	3.95	Black	PVC/PE/PP	Steel wire	PE/POM	C5-05022
6.0	2.8	4.75	Black	PVC	Steel wire	PE	C5-06028
7.0	3.2	5.9	Black	PVC	Steel wire	PE	C5-07032
8.0	3.8	6.8	Black	PVC	Steel wire	PE/POM	C5-08038
9.0	4.1	7.8	Black	PVC	Steel wire	PE	C5-09041
10.0	4.7	8.4	Black	PVC	Steel wire	PE	C5-10047
12.0	4.5	9.2	Black	PVC	Steel wire	POM	C5-12045

- ◆ 此套管应用最广泛;
- ◆ 主要用于汽车、座椅、电摩、童车、健身器等;
- ◆ This kind of Conduit is used most widely.
- ◆ Mainly used for Automobile, Seat, Electric Motorcycle, Pram, Fitness Equipment etc.

■ 扁丝管(不含内衬管)
■ Flat Wire Conduit(No Inner Tube)

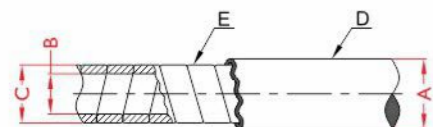

φA ±0.3mm	φB ±0.2mm	φC ±0.2mm	表面颜色 Surface Color	材质 Material		项目编号 Item No.
				D	E	
7.0	4.0	5.5	Black	PVC	Steel wire	C6-07040
9.0	6.2	8.0	Black	PVC	Steel wire	C6-09062
11.0	7.0	9.0	Black	PVC	Steel wire	C6-11070
12.0	8.0	10.4	Black	PVC	Steel wire	C6-12080
13.0	9.0	11.2	Black	PVC	Steel wire	C6-13090

- ◆ 此类套管主要用来保护软轴、传递、和定位等。
- ◆ This kind of Conduit mainly used for protecting the flexible shaft, transfer and fixed position and so on.

■ 圆丝管
■ Round Wire Conduit

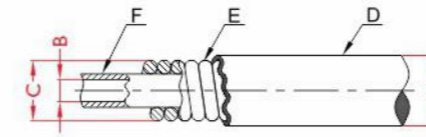

φA ±0.2mm	φB ±0.2mm	φC ±0.2mm	表面颜色 Surface Color	材质 Material			项目编号 Item No.
				D	E	F	
5.8	2.2	4.9	Black	PVC	Steel wire	PE	C7-05822

- ◆ 此类管主要用于园林机械(油门, 控制线);
- ◆ "E" 部位材质有72A (本色) 和 72A (镀锌) 两种。
- ◆ This kind of Conduit is mainly used in garden machinery (throttle, control cable).
- ◆ The material of "E" part could be 72A (Natural Color) or 72A (Zinc plating).

■ 直丝管
■ Straight Wire Conduit

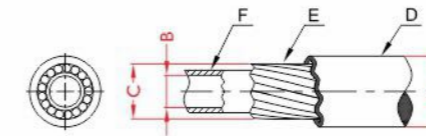

φA ±0.2mm	φB ±0.2mm	φC ±0.2mm	表面颜色 Surface Color	材质 Material			项目编号 Item No.
				D	E	F	
4.18	1.8	3.1	Black	PP	Steel wire	PE	C8-04218
5.0	2.0	3.7	Black/Grey	PE	Steel wire	PE	C8-05020
6.3	2.2	5.2	Red	PE	Steel wire	POM	C8-06322
9.5	3.8	7.5	Red	PE	Steel wire	POM	C8-09538
10.0	4.2	7.8	Grape purple	PE	Steel wire	POM	C8-10042

- ◆ 直丝管主要用于汽车换挡线及各种液压传动系统的控制, 具有高抗拉及高抗压强度。
- ◆ Straight wire conduit mainly used for the automotive's shift cable and all kinds of hydraulic drive system's control, with high tensile strength and high compressive strength.

■ 钢带直丝管
■ Straight Wire Conduit With Steel Strip

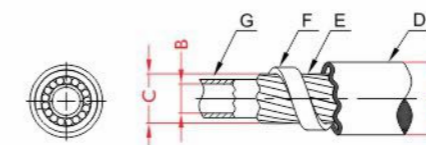

φA ±0.2mm	φB ±0.2mm	φC ±0.2mm	表面颜色 Surface Color	材质 Material				项目编号 Item No.
				D	E	F	G	
6.9	2.5	5.3	Grey	PP	Steel wire	Steel wire	POM	C9-06925
11.3	4.6	8.3	Black	PE	Steel wire	Steel wire	POM	C9-11346

- ◆ 套管孔径和钢丝绳外径的配合关系:
- ◆ 钢丝绳最大外径=φB(套管孔径)-0.4。
- ◆ The fit relationship between conduit and wire rope.
- ◆ Max outer dia of wire rope = φB(inner dia of conduit)- 0.4

钢丝绳末端配件 Wire Rope End Fittings



压铸端子

Die Casting Ends

- 类型: 竖向圆柱形
材质: 锌合金
- Type: Barrel Fitting
Material: Zinc Alloy

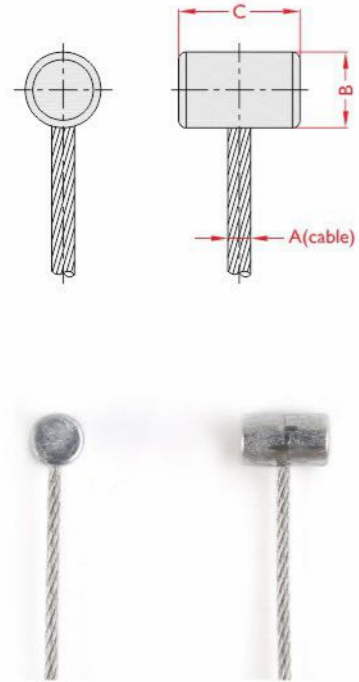

φA For cable φmm	φB ±0.2mm	C ±0.3mm	项目编号 Item No.
0.8	3.0	5.0	V083050
0.8	4.0	6.0	V084060
0.8	5.0	4.5	V085045
1.0	3.0	5.0	V103050
1.0	4.0	5.0	V104550
1.0	5.0	6.0	V105060
1.0	6.0	6.0	V106060
1.0	7.0	7.0	V107070
1.2	3.5	5.0	V123550
1.2	4.0	5.0	V124050
1.2	4.5	5.0	V124550
1.2	4.5	5.5	V124555
1.2	5.0	7.0	V125070
1.2	6.0	6.0	V126060
1.5	4.0	5.5	V154055
1.5	4.5	5.0	V154550
1.5	5.0	6.0	V155060
1.5	5.5	6.4	V155564
1.5	6.0	7.0	V156070
1.5	7.0	7.0	V157070
1.5	8.0	9.0	V158090
2.0	6.0	10.0	V206010
2.0	7.0	7.0	V207070
2.0	8.0	9.0	V208090
2.5	6.0	10.0	V256010
2.5	8.0	10.0	V258010
2.5	12.0	14.0	V251214

- ◆ 钢丝绳压铸接头最小破断强度=钢丝绳最小破断强度 × 70%。
- ◆ The min breaking strength of the die casting joint = The min breaking strength of the wire rope × 70%.

- 类型: 横向圆柱形
材质: 锌合金
- Type: Slug Fitting
Material: Zinc Alloy



φA For cable φmm	φB ±0.2mm	C ±0.3mm	项目编号 Item No.
0.8	3.0	4.0	H083040
0.8	5.0	3.0	H085030
0.8	10.0	5.0	H081050
1.0	3.0	4.0	H103040
1.0	4.0	5.0	H104050
1.0	4.5	4.5	H104545
1.0	5.0	6.0	H105060
1.2	3.0	4.0	H123040
1.2	4.0	4.0	H124040
1.2	5.0	8.0	H125080
1.5	4.0	4.0	H154040
1.5	4.0	4.0	H154040
1.5	5.0	6.0	H155060
1.5	6.0	6.0	H156060
1.5	6.3	6.2	H156362
1.5	7.0	9.8	H157098
1.5	7.9	12.7	H157913
1.5	4.0	4.0	H154040
1.5	5.0	5.0	H155050
2.0	6.0	7.0	H206070
2.5	6.0	6.0	H256060
2.5	7.0	7.0	H257070
2.5	12.0	14.0	H251214
3.0	7.8	10.0	H307810

- 类型: "Q"形
材质: 锌合金
- Type: "Q" Fitting
Material: Zinc Alloy

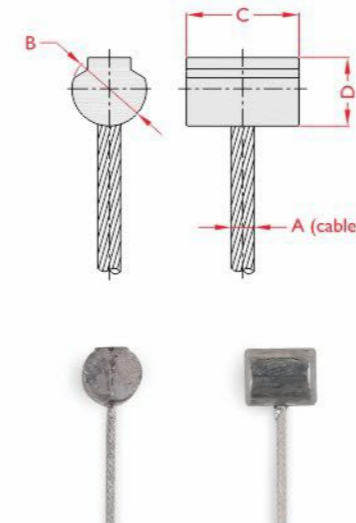

φA For cable φmm	φB ±0.2mm	C ±0.3mm	D ±0.3mm	项目编号 Item No.
0.8	5.00	6.30	5.00	Q085063
0.8	5.36	6.30	5.0	Q085463
0.8	4.00	6.30	5.0	Q084063
0.8	4.30	6.35	5.0	Q084364
1.0	3.80	6.35	3.2	Q103864
1.0	4.00	6.30	5.0	Q104063
1.2	3.70	9.50	5.2	Q123795
1.2	3.80	6.35	3.2	Q123864
1.2	3.90	6.00	5.0	Q123864
1.2	4.30	6.35	5.3	Q124364
1.5	5.36	6.35	5.0	Q155464
1.5	6.00	9.58	5.5	Q156096
1.7	6.10	9.25	5.7	Q176193

- ◆ 只列出一部分压铸端子规格, 如果目录没有找到您需要的规格, 请联系我们。
- ◆ Just list parts of the die casting ends specifications, if you want any other specs, please just feel free to contact with us. Thanks.

■ 类型: R形
材质: 锌合金
■ Type: Paddle Fitting
Material: Zinc Alloy

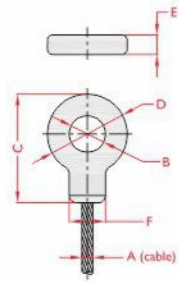

φA For cable φmm	φB ±0.2mm	C ±0.5mm	φD ±0.3mm	E ±0.3mm	F REF mm	项目编号 Item No.
0.8	5.0	16.0	11.0	3.0	5.2	R085016
1.0	3.2	11.5	7.0	3.0	6.0	R103212
1.0	4.2	15.0	8.0	3.2	2.7	R104215
1.0	5.2	14.5	10.0	2.9	5.0	R105215
1.0	7.0	33.9	11.5	3.0	5.0	R107034
1.0	8.0	19.0	14.0	6.0	3.1	R108019
1.0	9.0	19.0	14.0	3.0	6.0	R109019
1.2	3.5	11.0	8.0	-	-	R123511
1.2	4.2	12.5	9.0	3.0	3.0	R124213
1.2	5.0	15.0	11.0	3.0	5.0	R125015
1.2	5.5	12.0	12.0	2.0	-	R125512
1.2	6.5	15.0	10.2	2.7	4.4	R126515
1.5	5.0	15.0	11.0	5.0	3.0	R155015
1.5	6.5	20.0	14.0	4.0	4.3	R156520
1.5	8.5	27.8	17.6	6.0	-	R158528
2.0	5.2	15.3	11.0	4.6	-	R205215
2.0	6.0	17.8	11.8	4.8	4.8	R206018
2.0	6.5	18.5	14.6	4.3	4.8	R206519
2.5	5.0	23.5	12.0	4.0	-	R255024
2.5	6.5	18.5	15.0	4.6	4.8	R256519
2.5	8.4	27.4	16.2	5.8	5.8	R258427

■ 类型: Z形
材质: 锌合金
■ Type: "Z" Fitting
Material: Zinc Alloy

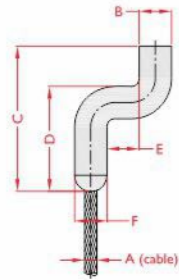

φA For cable φmm	φB ±0.2mm	C ±0.5mm	D ±0.3mm	E ±0.2mm	φF ±0.2mm	项目编号 Item No.
0.8	2.0	9.8	6.7	3.05	2.67	Z082010
0.8	2.0	12.0	7.0	3.05	2.67	Z082012
0.8	2.0	14.8	10.5	3.05	2.70	Z082015
0.8	2.0	16.0	10.2	3.05	2.67	Z082016
1.0	2.0	16.0	10.2	8.4	3.0	Z102015
1.0	3.0	21.5	14.5	7.0	3.0	Z103022
1.0	3.0	20.0	13.0	9.0	3.0	Z103020
1.2	4.2	21.8	10.8	3.6	4.2	Z124222
1.2	4.1	20.5	-	-	-	Z124121
1.2	4.1	28.0	-	-	9.6	Z124128
1.2	4.2	21.6	15.0	3.4	4.2	Z134222
1.5	4.0	16.0	9.0	4.0	4.0	Z154016
1.5	4.2	20.8	14.9	3.6	4.2	Z154221
1.5	4.2	22.5	15.4	4.1	4.2	Z154223
1.5	4.4	21.9	15.4	3.5	4.4	Z154422
1.8	5.0	22.7	12.0	13.0	5.0	Z185023
2.0	4.2	22.0	11.2	4.0	4.2	Z204222
2.0	6.0	30.0	18.0	6.0	6.0	Z206030
2.5	4.2	20.3	14.8	5.4	4.2	Z254220
2.5	4.3	20.3	9.4	10.9	4.3	Z254320
4.0	5.8	29.8	22.8	6.5	4.3	Z405830

■ 类型: "T"形
材质: 锌合金
■ Type: "T" Fitting
Material: Zinc Alloy

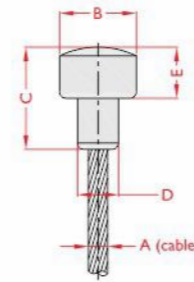

φA For cable φmm	φB ±0.2mm	C ±0.5mm	φD ±0.2mm	E ±0.2mm	项目编号 Item No.
0.8	4.9	6.3	2.3	4.0	T084863
0.8	7.6	6.4	2.3	4.0	T087664
1.0	6.0	4.5	3.8	1.5	T106045
1.0	9.5	7.0	6.0	4.0	T109570
1.0	12.5	6.5	8.5	-	T101365
1.0	7.0	7.5	3.5	3.5	T107075
1.2	6.0	8.0	3.2	4.0	T126080
1.2	8.0	10.0	5.5	4.0	T128010
1.5	5.5	9.6	3.0	3.0	T155596
1.5	6.0	8.0	3.2	4.0	T156080
1.5	8.0	10.0	5.5	4.5	T158010
1.5	6.0	9.0	4.0	3.0	T156090
2.0	5.5	10.0	3.5	-	T205510
2.0	6.0	10.0	4.0	-	T206010
2.0	6.5	8.5	5.0	4.5	T206585
2.5	6.0	11.0	4.0	-	T256011
2.5	12.0	27.0	6.0	8.0	T251227

■ 类型: 球形
材质: 锌合金
■ Type: Ball Fitting
Material: Zinc Alloy

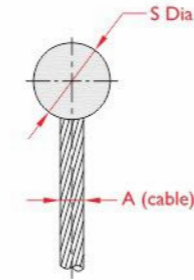

φA For cable φmm	Sφ ±0.2mm	项目编号 Item No.
0.8	3.0	S0830
0.8	4.0	S0840
0.8	4.5	S0845
1.0	3.0	S1030
1.0	3.5	S1035
1.0	4.0	S1040
1.0	4.5	S1045
1.2	4.8	S1248
1.2	6.0	S1260
1.2	7.4	S1274
1.5	3.8	S1538
1.5	4.4	S1544
1.5	5.0	S1550
1.5	5.5	S1555
1.5	6.0	S1560
1.5	7.5	S1575
2.0	6.5	S2065
2.0	7.5	S2075
2.5	6.0	S2560
2.5	8.2	S2582

■ 类型: 异形 材质: 锌合金
 ■ Type: Other Fittings Material: Zinc Alloy

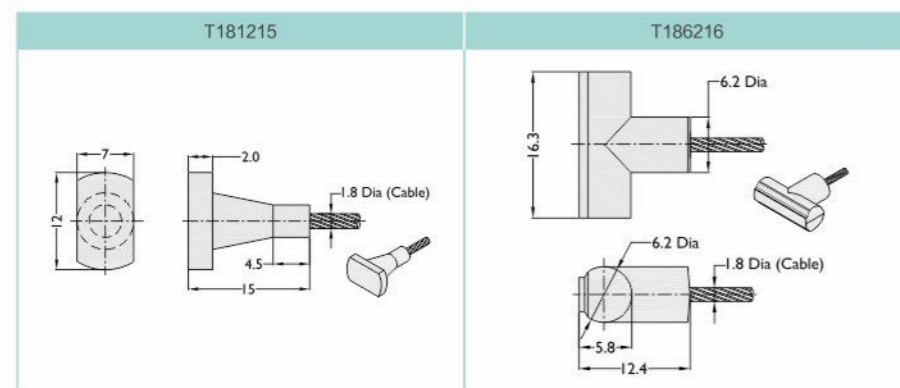
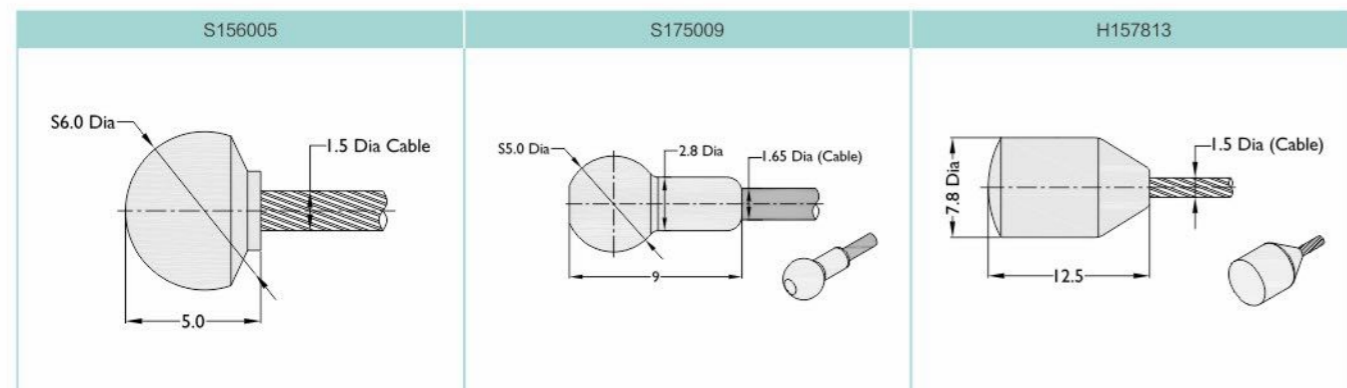
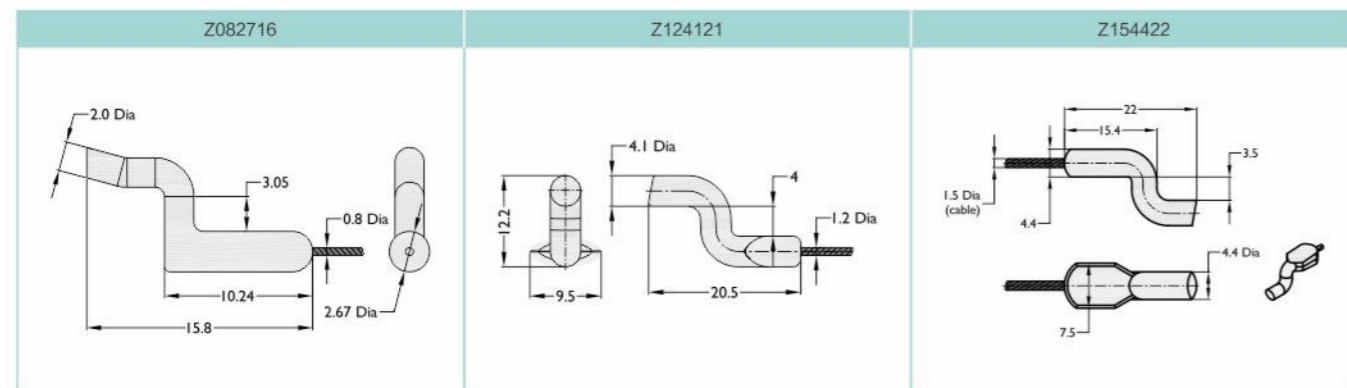
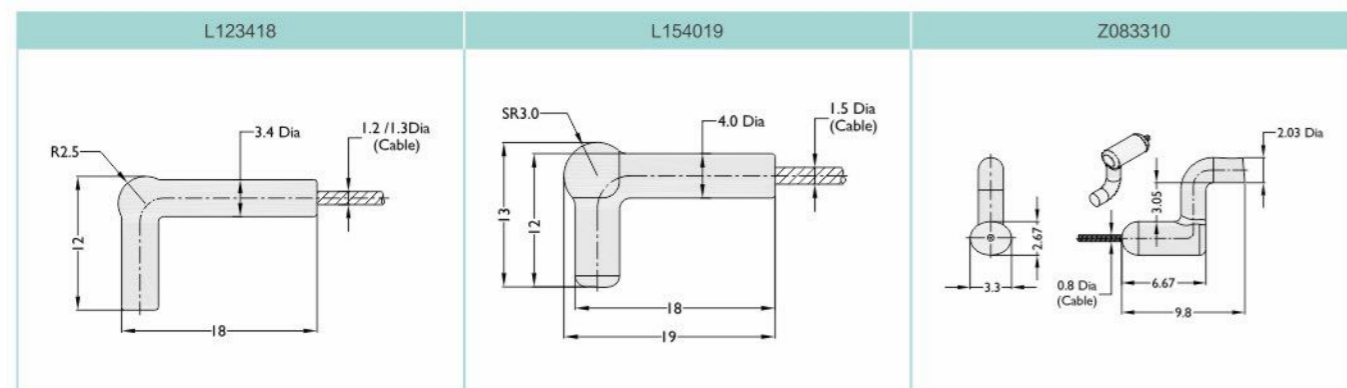

■ 钢丝绳末端配件---螺杆
 ■ Wire Rope End Fittings---Screw Rod Fittings



A For cable ϕ mm	B mm	C Ref mm	D \pm 1mm	最小破断强度 Min. Break Strength kgf	项目编号 Item No.
1.2	M4	11	7	65	244011
1.5	M4	10	5	100	240410
1.5	M5	40	30	100	240540
2.0	M5	50	38	150	240550
2.0/2.5	M6	60	39	150	240660
2.5/3.0	M6	36	20	220	240636
3.18	M6	52	32	250	240652
3.5	M6	58	40	320	240658
3.5	M8	55	40	320	240855

■ 钢丝绳末端配件---铆合端子
 ■ Wire Rope End Fittings---Riveting Fittings

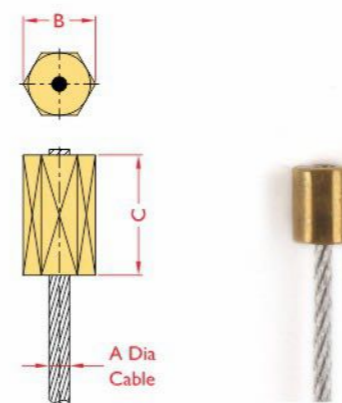

A For cable ϕ mm	B \pm 0.2 mm	C Ref mm	材料 Material	最小破断强度 Min. Break Strength kgf	项目编号 Item No.
0.8	3	4	Brass	15	233040
1.0	3.5	4	Brass	15	233540
1.8	5	5	Brass	30	235050
3.5	9	15	Steel	600	239015

■ 钢丝绳末端配件---铆合球头
 ■ Wire Rope End Fittings---Ball Fittings

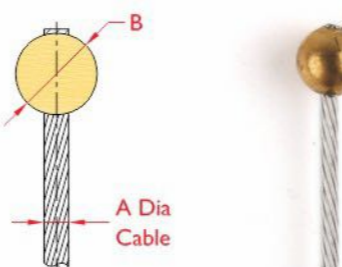

A For cable ϕ mm	ϕ B \pm 0.2 mm	材料 Material	最小破断强度 Min. Break Strength kgf	项目编号 Item No.
1.2	4.1	Brass	20	231241
1.2	4.5	Brass	40	231245

■ 钢丝绳末端配件---R形锻造端子
■ Wire Rope End Fittings---Paddle Fittings

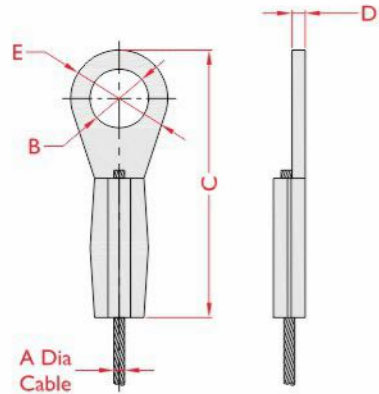

A For cable ϕ mm	ϕ B ± 0.2 mm	C Ref mm	D ± 0.15 mm	ϕ E ± 0.3 mm	材料 Material	项目编号 Item No.
<1.3	3.2	13.5	0.7	6	Stainless steel	113214
<1.3	3.6	13.7	0.7	6	Stainless steel	113614
<2.4	4.0	16.5	0.7	8	Stainless steel	114017
<1.8	4.2	22	0.9	8.6	Stainless steel	114222
<3.4	4.5	35	2	9	Zinc plated steel	114535
<2.3	5.0	29	1.5	10.8	Stainless steel	115029
<2.3	5.5	31	1.5	9.6	Zinc plated steel	115531
<4.0	6.3	36.5	2	12.9	Zinc plated steel	116337
<2.3	6.5	29.5	1.5 / 2.0	10.8	Zinc plated steel	116530
<2.3	7.0	29.5	1.5	10.8	Stainless steel	117030
<5.0	8.2	58.5	3	17	Zinc plated steel	118259
<1.5	8.7	26	1	15	Zinc plated steel	118726
<2.6	9.6	45	2.5	19	Zinc plated steel	119645

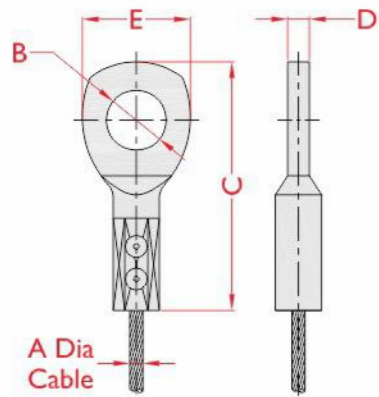

A For cable ϕ mm	ϕ B ± 0.15 mm	C Ref mm	D ± 0.2 mm	E Ref mm	材料 Material	项目编号 Item No.
1.5	6.3	26.5	2.0	11	Zinc plated steel	306427
1.5	7.0	26.5	2.0	11	Zinc plated steel	307027
2.5-4.0	8.5	46	4.1	20.3	Zinc plated steel	308546
2.5-4.0	11	46	4.1	20.3	Zinc plated steel	301146
5.0-8.0	12	56	6.1	26.7	Zinc plated steel	301256
2.5-4.0	13.0	46	4.1	20.3	Zinc plated steel	301346



■ 钢丝绳末端配件---铝套
■ Wire Rope End Fittings
---Aluminum Sleeves

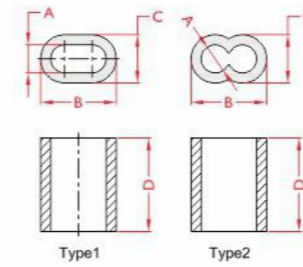

ϕ A ± 0.2 mm	B ± 0.2 mm	C ± 0.2 mm	D Ref mm	项目编号 Item No.	类型 Type
1.4	4	2.8	4.8	601440	Type1
1.4	4.8	3.1	7	601448	
2.1	6.3	4.3	7	602163	Type2
2.1	6.3	4.3	8	602164	
2.8	7.7	5.3	9	602877	
3.7	10.1	6.9	12	603710	
4.5	14	9.5	16	604514	
5.8	16.8	11	12	605817	
6.2	16.9	11	20.4	606217	
7.6	20.2	12.9	25	607620	

■ 钢丝绳末端配件---钢丝绳打圈
■ Wire Rope End Fittings
---Wire Rope Loop

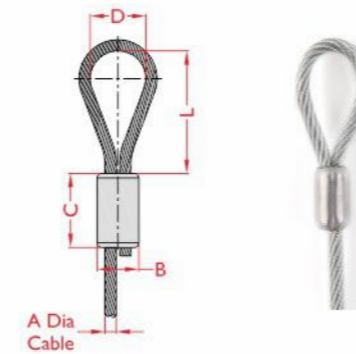

ϕ A For cable ϕ mm	ϕ B Ref mm	C Ref mm	项目编号 Item No.
$0.5 \leq \phi \leq 1.0$	3.1	6	603160
$0.5 \leq \phi \leq 1.0$	3.4	8	603480
$1.2 \leq \phi \leq 1.8$	4.5	8.5	604585
$1.2 \leq \phi \leq 1.8$	4.5	9.5	604595
$1.5 \leq \phi \leq 2.5$	5.8	10.5	605811
$2.0 \leq \phi \leq 3.2$	7.5	14	607514
$3.0 \leq \phi \leq 4.0$	10.5	18	601118
$4.0 \leq \phi \leq 5.5$	12	15	601215
$4.5 \leq \phi \leq 6.0$	12	25	601225
$6.0 \leq \phi \leq 7.0$	15	26	601526

◆尺寸"D" "L"由顾客根据需求提供;
◆零件材质为: 铝(自然色).
◆The spec of "D" and "L" are according to the customer's requirement.
◆Materials: Aluminum (Natural color).

■ 钢丝绳末端配件---三角扣环(不锈钢)
■ Wire Rope End Fittings
---Thimble(stainless steel)

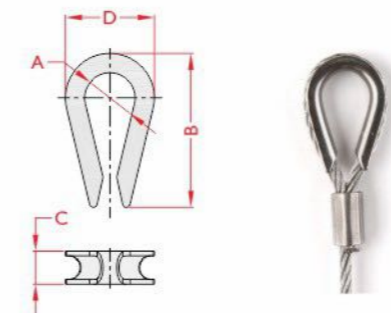

ϕ A ± 0.5 mm	B Ref mm	C mm	D Ref mm	项目编号 Item No.
7.2	20	<4.5	12	187220
10	23	<5.5	15.5	181023
13	32	<8.0	20.5	181332
20	49.5	<12.5	30.3	182050

■ 钢丝绳末端配件---U形端子
■ Wire Rope End Fittings---U Forks

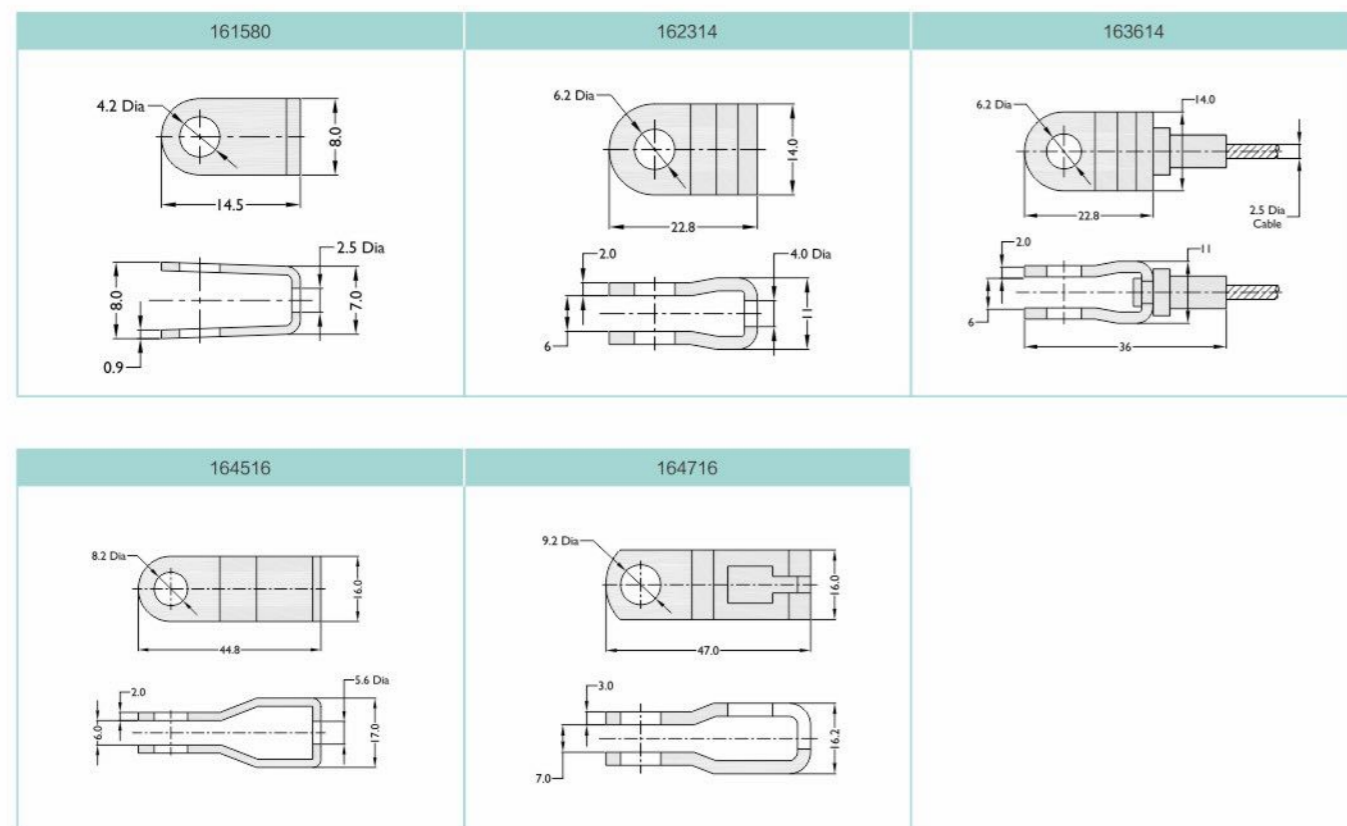

■ 钢丝绳末端配件---葫芦钩
■ Wire Rope End Fittings---Hooks

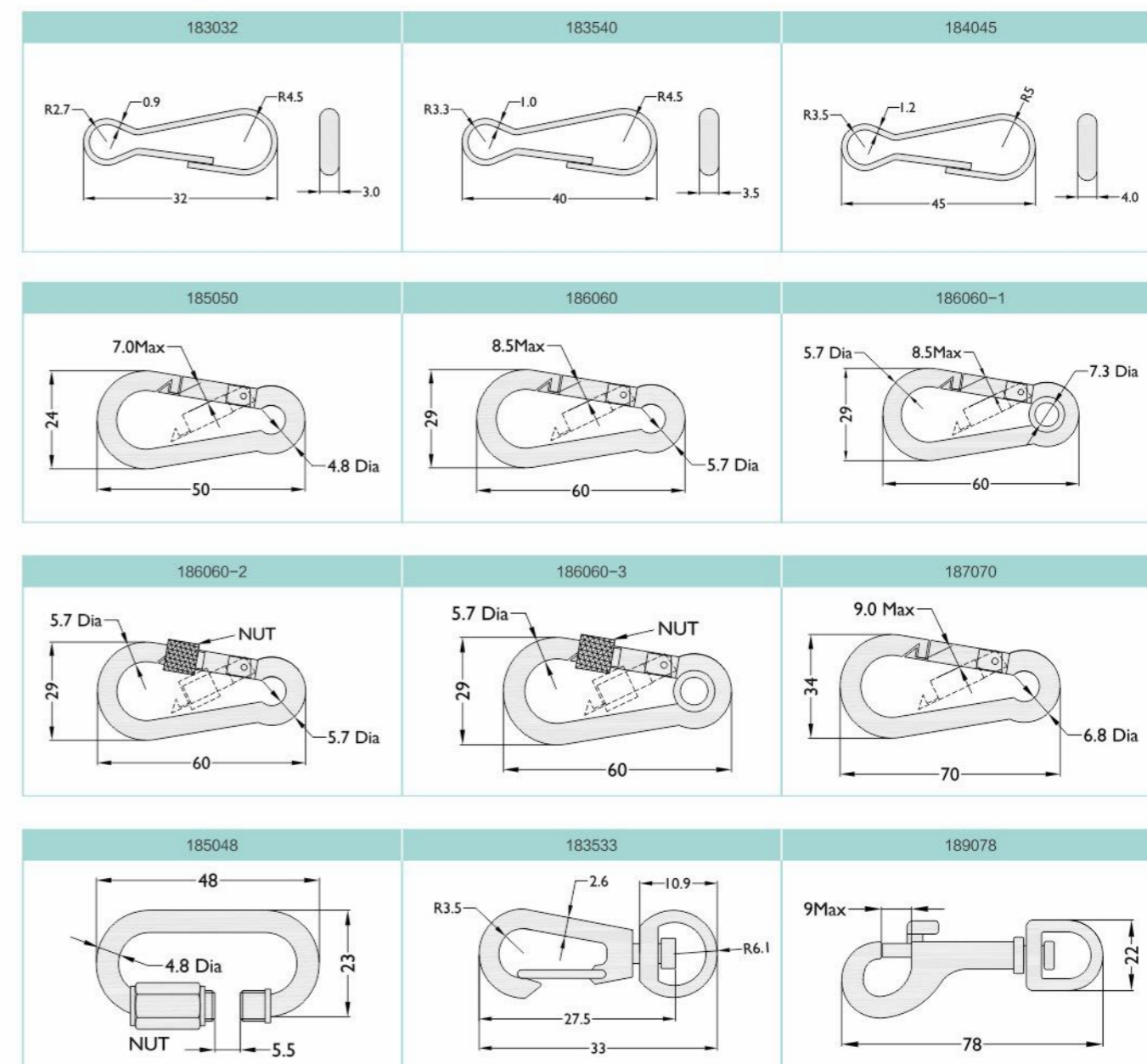

■ 钢丝绳末端配件---夹头
■ Wire Rope End Fittings---Clamps

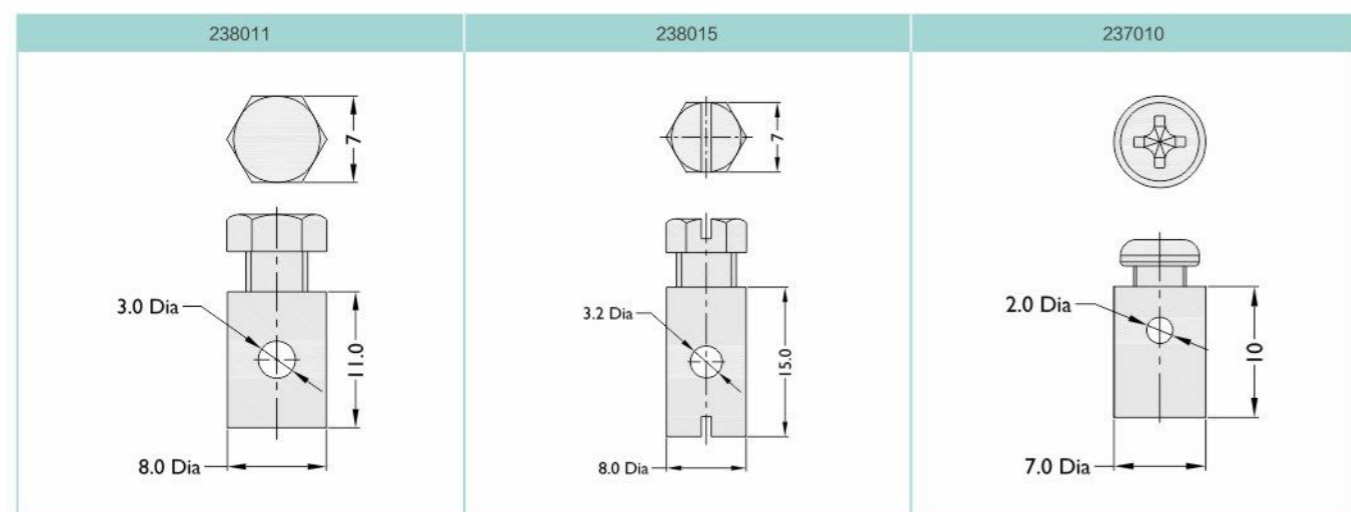
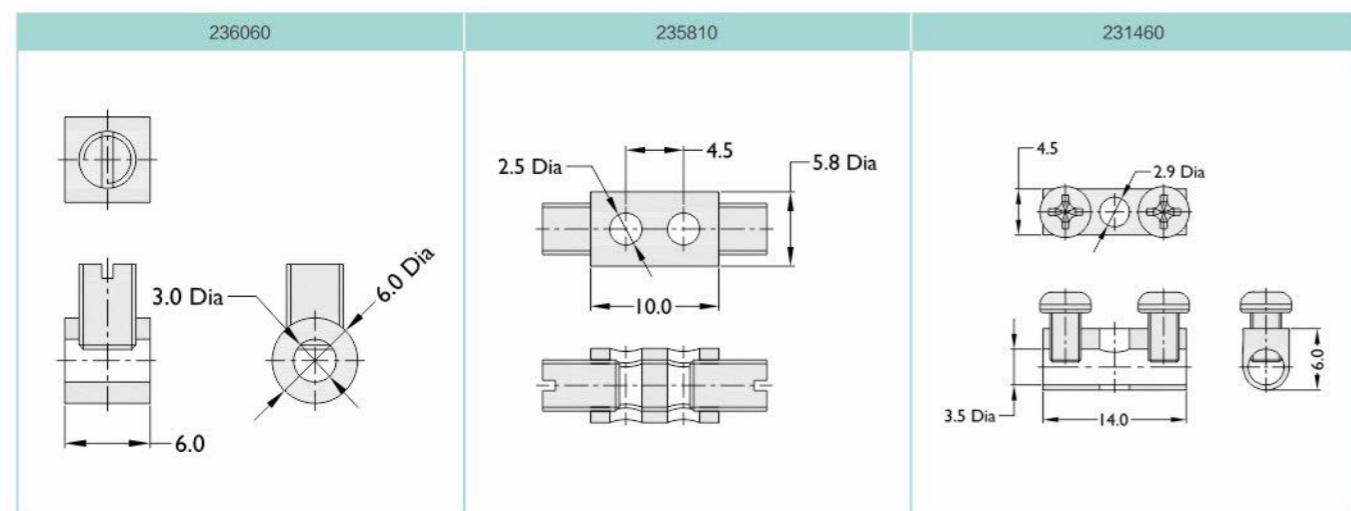

■ 钢丝绳末端配件---单向锁线器
■ Wire Rope End Fittings---Wire Locked Clips

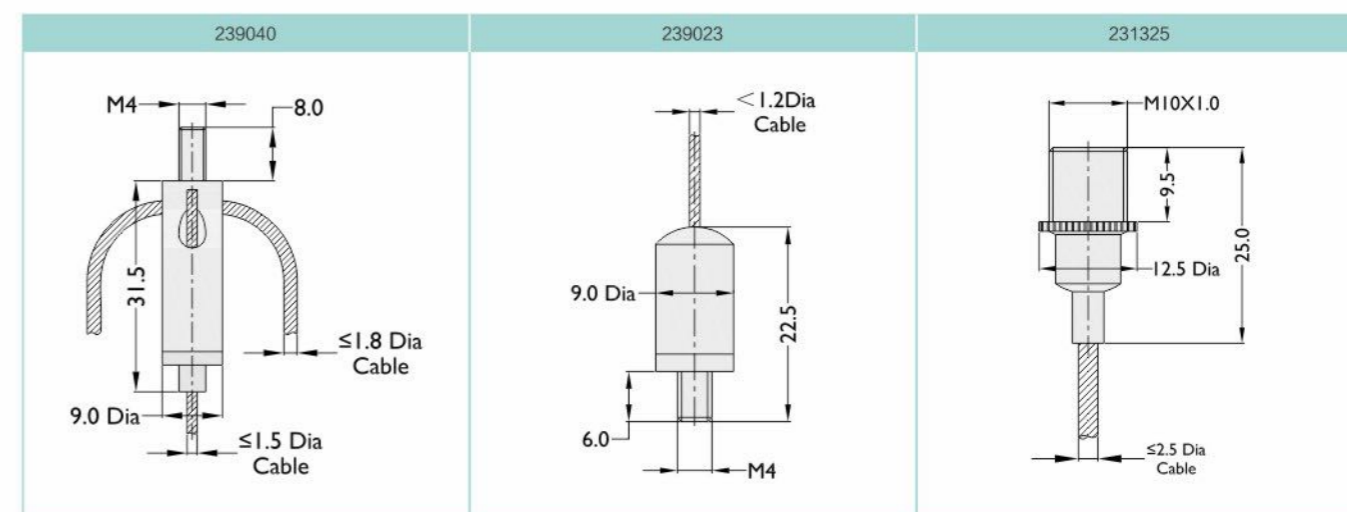
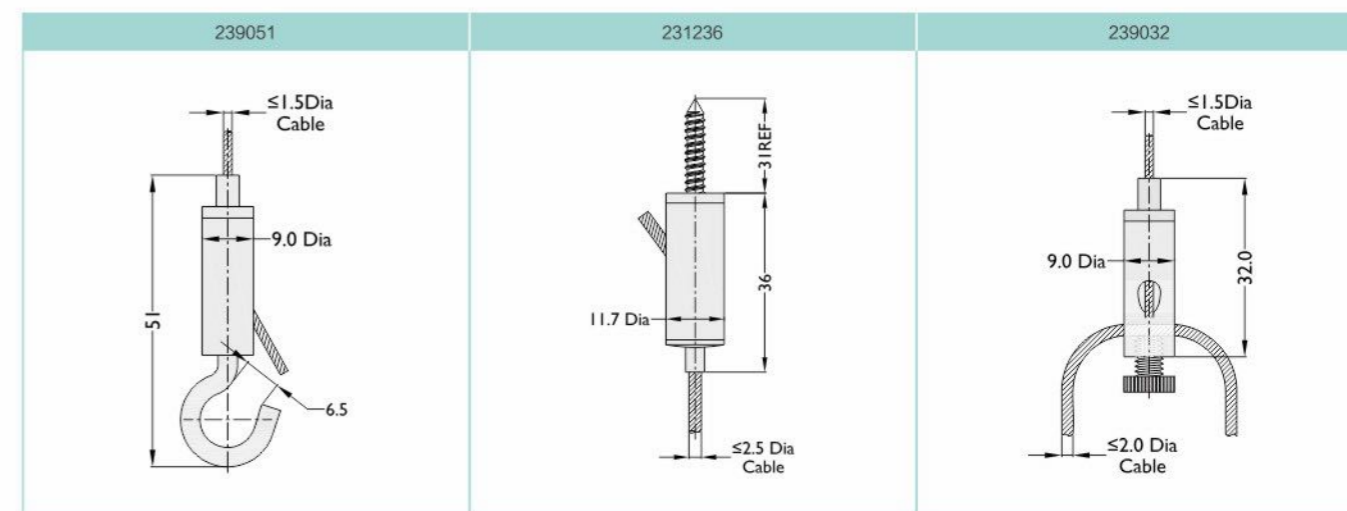

- 钢丝绳末端配件---吊灯固定底座
- Wire Rope End Fittings---Lighting Fixed Bases

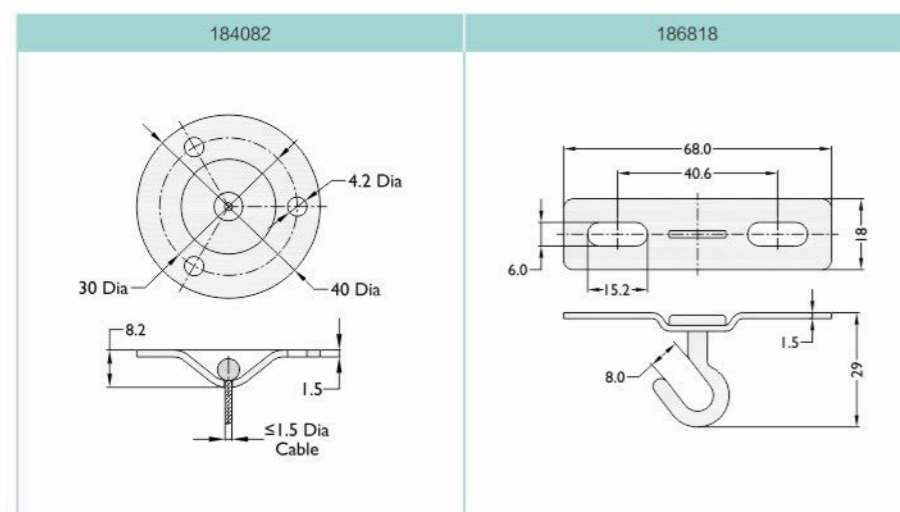
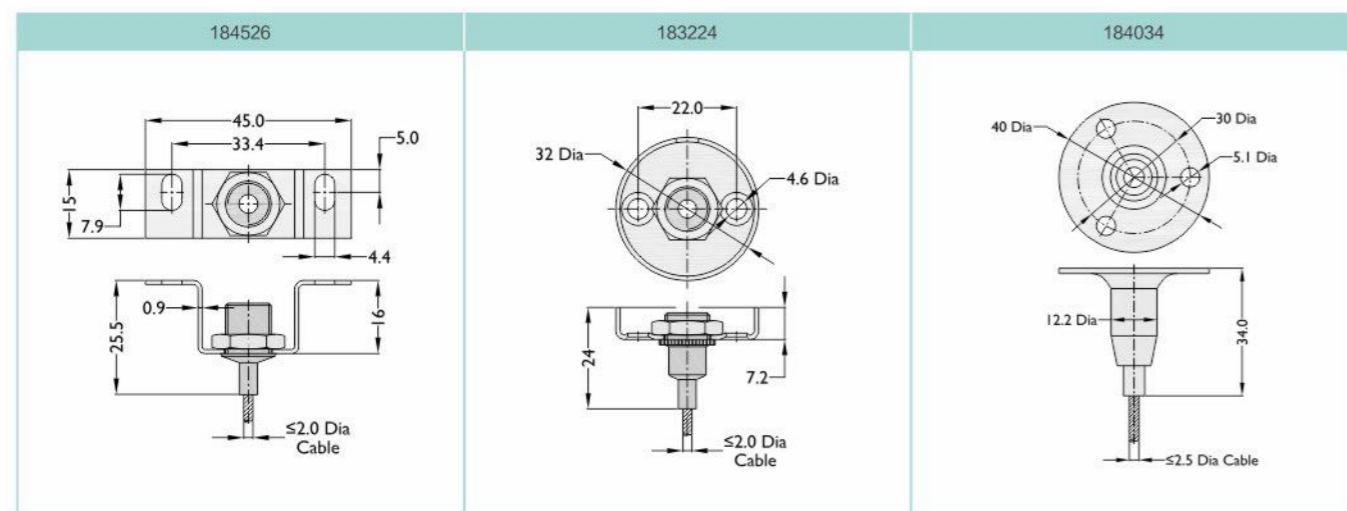

套管末端配件 Conduit End Fittings

- 套管末端配件---套管帽
- Conduit End Fittings---End Caps

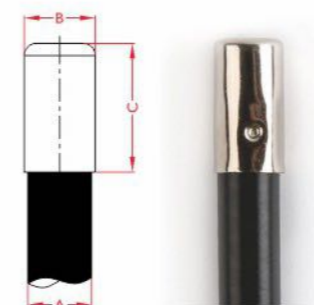

φA Conduit Dia mm	φB ±0.3mm	C ±1mm	项目编号 Item No.
3.6	4.2	10.5	614211
4.0	4.6	10.5	614611
5.0	5.4	10.5	615411
5.0	5.6	10.5	615611
5.0	5.6	12.0	615612
5.0	5.8	8.5	615885
5.0	5.8	10.5	615811
6.0	6.5	12.0	616412
7.0	7.6	14.0	617614
7.0	7.8	8.5	617885

- 套管末端配件---T形套管帽
- Conduit End Fittings---"T" Type Caps

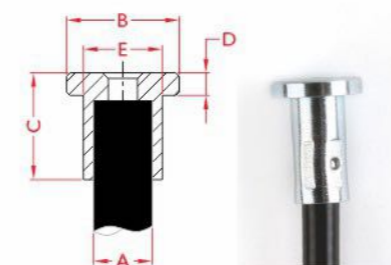

φA Conduit Dia mm	φB ±0.2mm	C Ref mm	D ±0.2mm	φE ±0.3mm	项目编号 Item No.
3.6	9.0	12.0	1.6	5.3	219012
5.0	10.0	11.5	3.5	7.0	211012
8.0	15.0	14.0	2.5	10.5	351514

■ 套管末端配件---T形套管帽
 ■ Conduit End Fittings---"T" Type Caps

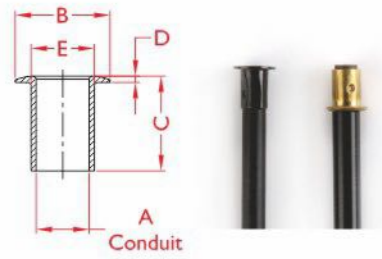

φA Conduit Dia mm	φB ±0.2mm	C Ref mm	D ±0.2mm	φE ±0.3mm	项目编号 Item No.
4.18	7.6	7.7	0.5	4.9	617677
5.0	7.4	7.4	0.8	5.0	617474

■ 套管末端配件---台阶管帽
 ■ Conduit End Fittings---Step Caps

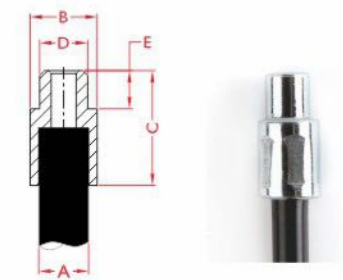

φA Conduit Dia mm	φB ±0.2mm	C Ref mm	φD ±0.15mm	E ±0.3mm	项目编号 Item No.
3.6	7.0	9.0	4.5	2.0	217090
4.0	6.0	16.3	4.0	6.5	216016
5.0	6.0	17.5	3.8	3.5	216018
5.0	7.0	23.0	4.5	10.0	217023
5.0	7.0	25.0	4.9	9.5	217025
5.0	7.0	22.0	5.3	14.0	217022
5.0	8.2	16.5	6.0	6.5	358217

■ 套管末端配件---套管帽
 ■ Conduit End Fittings---End Caps

217014	218024	217019

- ◆ 固定在套管的端部，保护套管及安装定位作用；
- ◆ 如果您需要一个其它规格，请联系我司技术顾问，我们可以为您定制。
- ◆ Fixed on the end of the Conduit to protect the sleeve and easy for fixture.
- ◆ It can be customized, please just feel free to contact us if you want the different specs.



■ 套管末端配件---螺栓
 ■ Conduit End Fittings---Screws

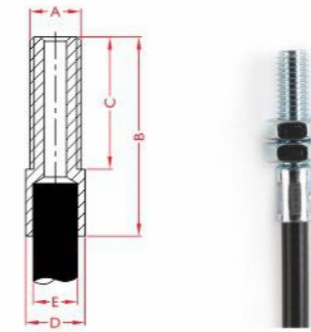

- ◆ 螺栓固定在套管上，螺栓不可移动、不可旋转。
- ◆ The screw is fixed and can't move & rotate.

A mm	B Ref mm	C ± 1.0mm	φD ± 0.2mm	E Conduit Dia mm	项目编号 Item No.
M4	17	10	5	3.6 / 4.0	224017
M4	27	20	5	3.6 / 4.0	224027
M5	28	18	7	5.0	225028
M5	31	21	7	5.0	315031
M6	25	15	7	5.0	316025
M6	31	21	7	4 / 5.0	316031
M6	35	25	7	5.0	316035
M6	45	30	7	5.0	316045
M8	52	40	9	6.0	318052
M8	60	40	9	6.0	318060
M8	65	45	9	7.0	318065
M8	70	55	9	7.0	318070
M10	76	55	11	9.0	311075

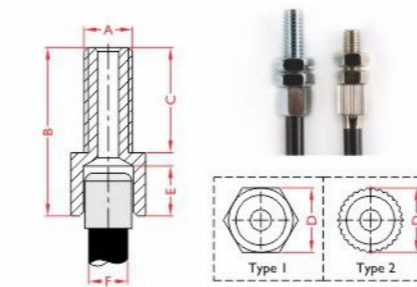

- ◆ 螺栓可移动，可旋转。
- ◆ The screw can move & rotate.

A mm	B ± 1mm	C ± 1mm	D ± 0.3mm	E ± 0.5mm	F Conduit Dia mm	项目编号 Item No.	类型 Type
M5	38	20	8	16	≤ 5.0	225038	Type1
M6	28	20.5	8	5	≤ 5.0	316028	
M6	34	21	8	9	≤ 5.0	316034	
M6	40	30	8	8	≤ 5.0	316040	
M8	45	35	9.8	8.5	≤ 7.0	318045	Type2
M5	22.5	14.5	8	6.5	≤ 5.0	225023	
M6	25	18	8.3	5.0	≤ 5.0	316024	

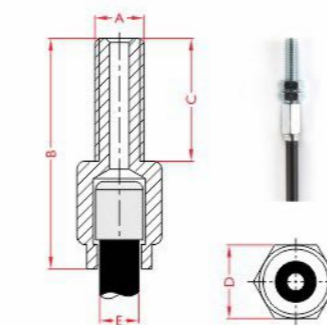

- ◆ 螺栓固定后不可移动，可旋转安装调节。
- ◆ The screw can rotate after fixture to adjust the travel.

A mm	B ± 1.0 mm	C ± 1.0mm	D mm	E Conduit Dia mm	项目编号 Item No.
M6	27	11	8	5.0	316027
M6	40	25	8	5.0	316040-2
M6	40	25	9.8	6.0	316040-3

■ 套管末端配件---塑料套管帽
 ■ Conduit End Fittings---Plastic Clips

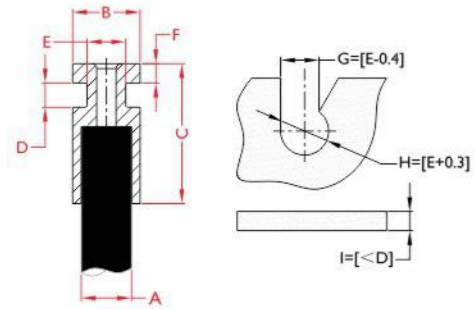

推荐配合槽尺寸
Recommended groove size

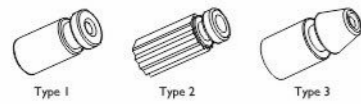

φA Conduit Dia mm	φB ±0.2mm	C ±0.5mm	D ±0.2mm	φE ±0.2mm	F ±0.3mm	材质 Material	项目编号 Item No.	类型 Type
3.6	7	17.4	3.5	3.5	2.5	POM	417017	Type1
3.6	6.9	19.5	3.5	4.9	4	PA	416920	
4.18	8	20	2.7	4.9	2.5	PA	418020	
4.18	8	30.2	2.4	4.9	6	PA	418030	
4.36	8.1	20.8	2.74	4.06	2.54	PA	418121	
4.0	7.8	19.6	2.4	4.8	2.5	PA	417820	
5.0	7.7	14.6	2.1	4.5	2.5	PA	417715	
5.0	7.8	17	2.2	4.6	1.5	PA	419017	
5.0	7.5	19	3.0	5	2	PA	417519	
5.0	9	19.5	3.56	4.75	2.5	PA	419020	
4.18	7.7	17.5	2.2	4.5	2.5	PA	417717	Type2
4.18	7.7	20.6	2.0	4.6	2.5	PA	417720	
5.0	7.7	17.5	2.2	4.5	2.5	PA	417718	
5.0	7.7	20.6	2	4.6	2.5	PA	417721	
5.0	8	22.3	2.3	4.9	6	PA	418022	Type3
5.0	8.8	22.3	2.6	4.9	6	PA	418822	
5.0	9	19.8	3.8	4.9	6	PA	419020	

■ 套管末端配件---金属套管帽
 ■ Conduit End Fittings---Metal Clips

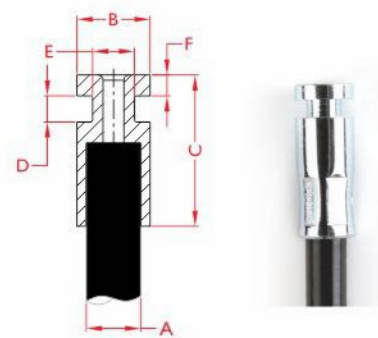

A Conduit Dia mm	φB ±0.2mm	C Ref mm	D ±0.15mm	φE ±0.1mm	F ±0.3mm	项目编号 Item No.
4.0	7	18	3.1	3.4	2.5	217018
5.0	7	21	1.5	4.3	5.5	357021
5.0	7	21	2.5	4.3	5.5	357021-1
5.0	7	18	3.1	3.3	2.5	217018-1
5.8	7	21	1.5	4.2	5.5	357021-2

■ 套管末端配件---塑料侧卡帽
 ■ Conduit End Fittings---Side Snap-in Clips

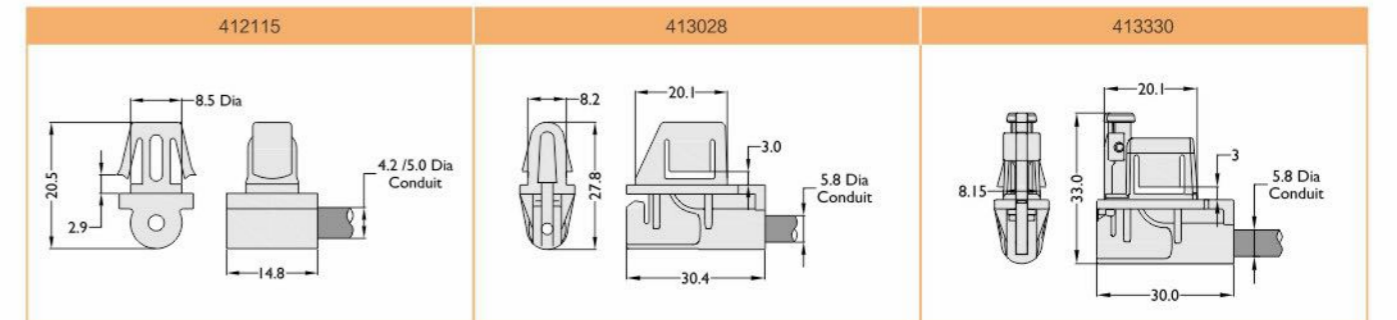
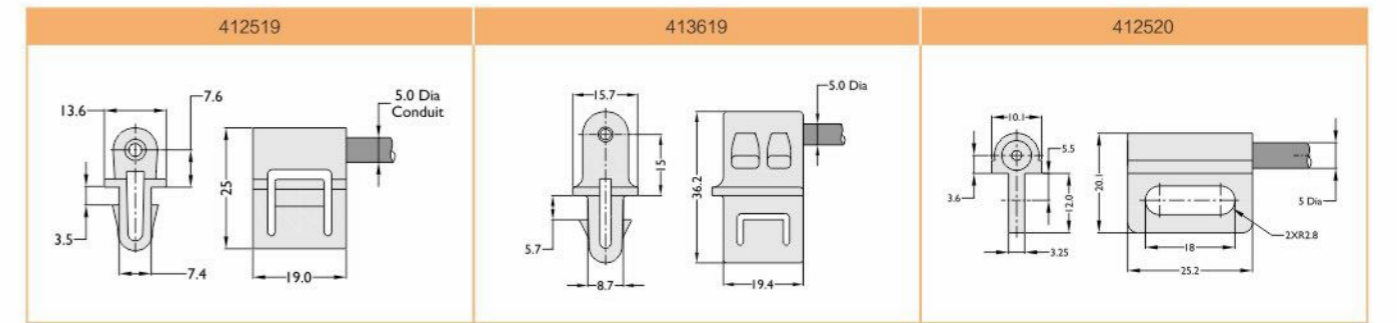

■ 套管末端配件---直卡帽
 ■ Conduit End Fittings---Straight Clips

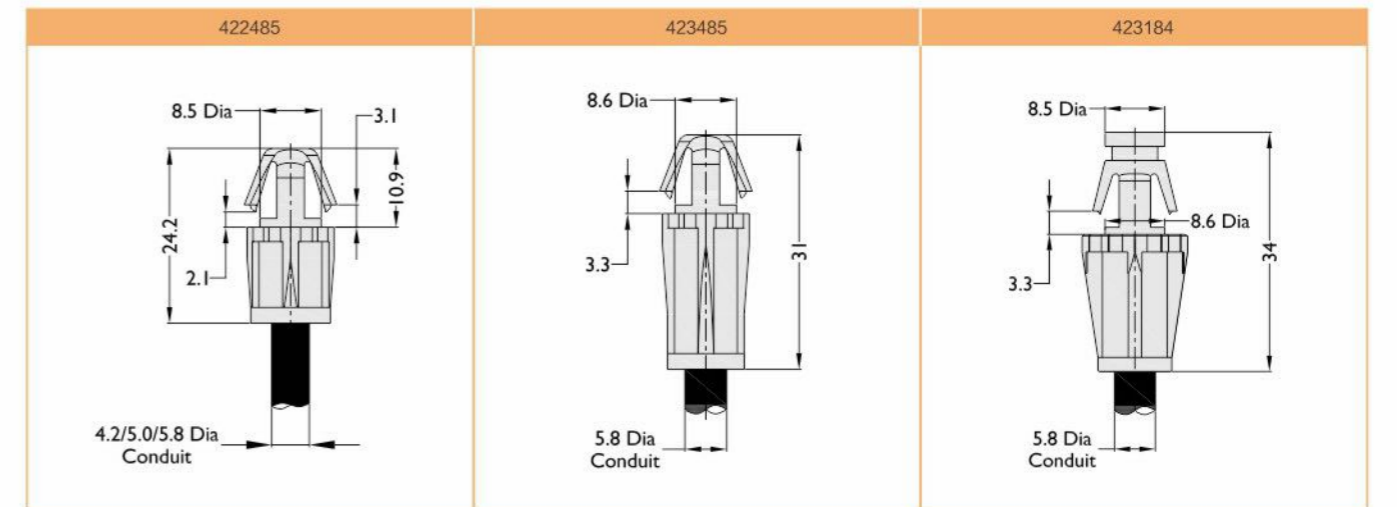

- 套管末端配件---四方帽
- Conduit End Fittings---Square Ends

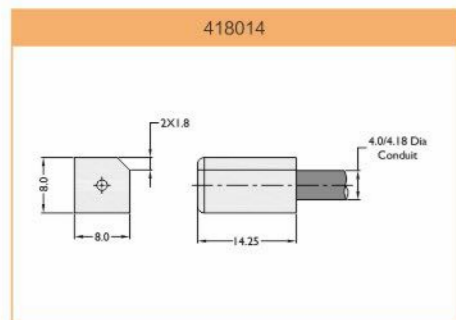

- 套管末端配件---支架
- Conduit End Fittings---Holder

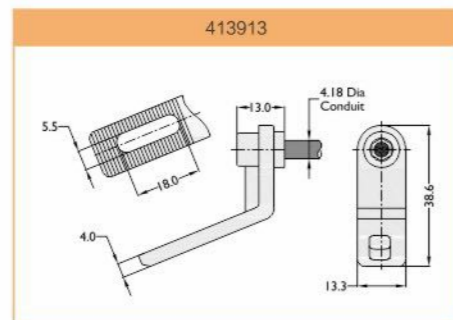

- 套管末端配件---C形卡座
- Conduit End Fittings---"C" Blocks

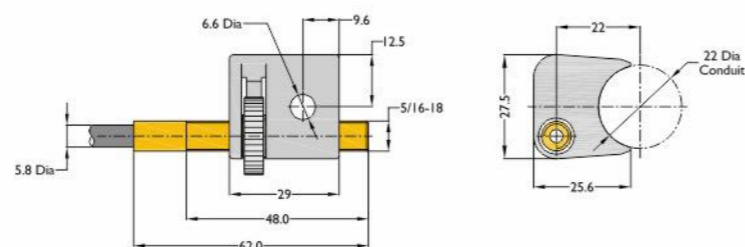
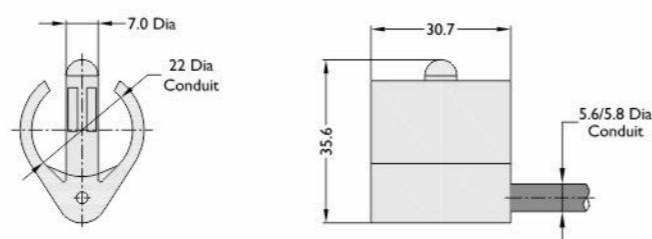
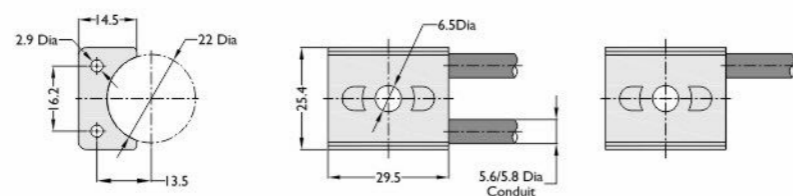

- 弯管
- Conduit Fittings---Bend Tubes



- 防尘帽
- Protect Caps



- 弹簧
- Springs



■ 套管配件---塑料调节螺栓组件
 ■ Conduit Fittings---Plastic Adjusting Screw Assembly

项目编号 Item No.
418350
材料 Material
尼龙 Nylon-Black

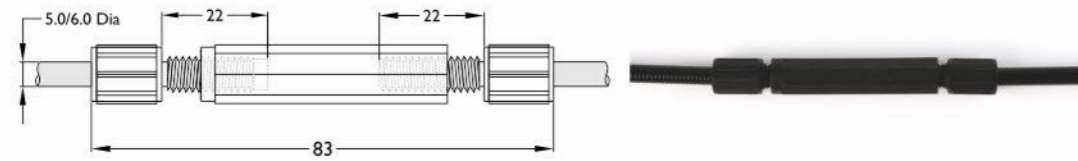

■ 套管配件---金属调节螺栓组件
 ■ Conduit Fittings---Metal Adjusting Screw Assembly

项目编号 Item No.
318360
材料 Material
Zincnickel plated steel

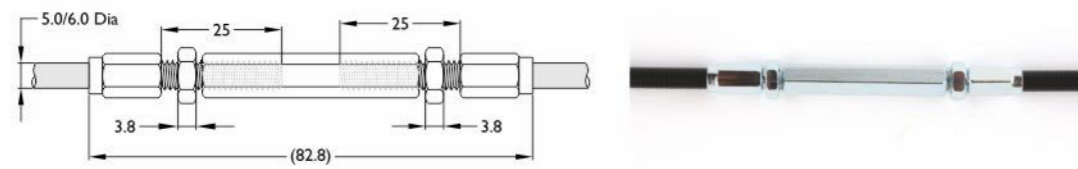

■ 套管配件---金属调节螺栓组件
 ■ Conduit Fittings---Metal Adjusting Screw Assembly

项目编号 Item No.
314750
材料 Material
Zincnickel plated steel

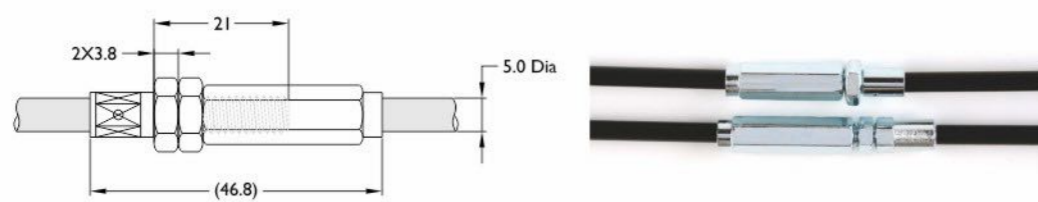

- ◆ 上面3种螺栓调节组件均用于增加管长 (L) 来减短行程 (A+B) 的作用;
- ◆ 用于产品长度较长且行程A+B要求较高的产品;
- ◆ A+B长度设计时需稍偏大, 才能起到调节作用。
- ◆ The above 3 adjust screws are used in increasing the tube length (L) to decrease the travel (A+B).
- ◆ Used for strict travel requirement products.
- ◆ The adjust screw can adjust when travel(A+B) is longer.

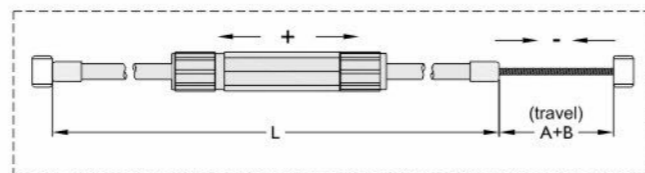

■ 套管配件---连接体
 ■ Conduit Fittings---Connectors

项目编号 Item No.
291361
材料 Material
铝 aluminium

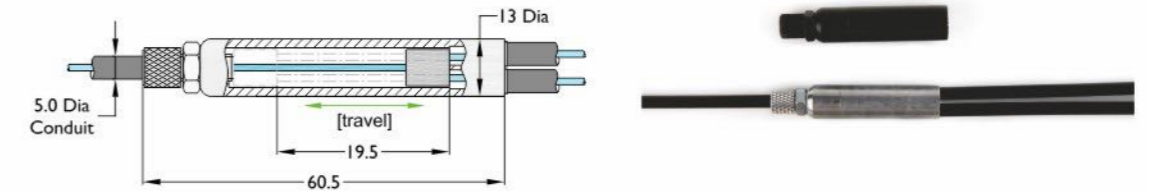

项目编号 Item No.
291356
材料 Material
铝 aluminium

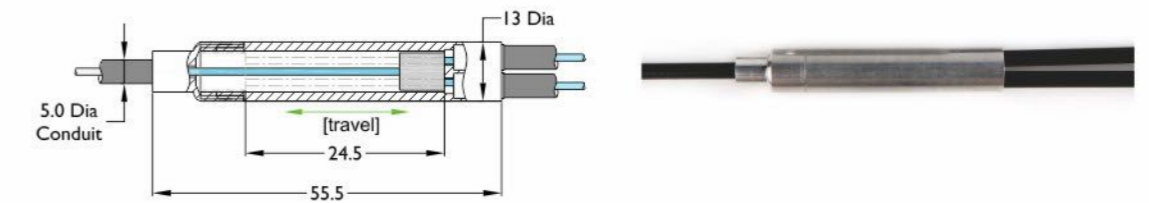

项目编号 Item No.
291377
材料 Material
铝 aluminium

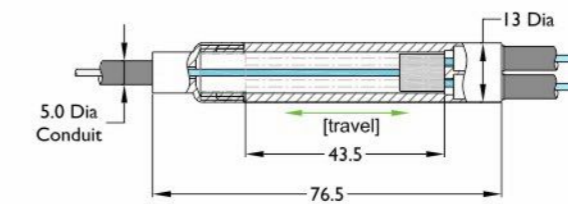

座椅拉索 Seat Cable



■ 座椅底盘控制拉索
■ Cables for Chair Chassis

项目编号
Item No.
32361

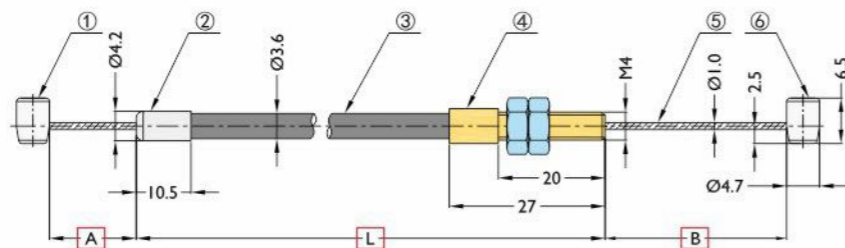

项目编号
Item No.
32501

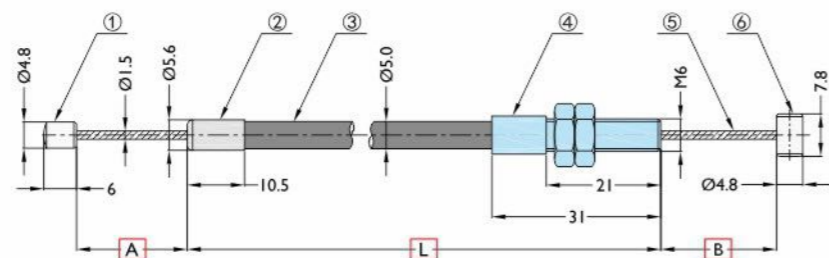

项目编号
Item No.
32362

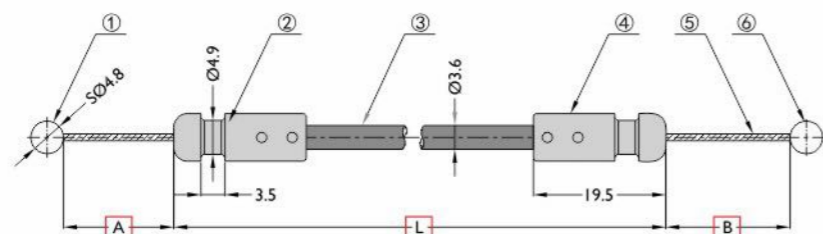

■ 座椅底盘控制拉索
■ Cables for Chair Chassis

项目编号
Item No.
32101

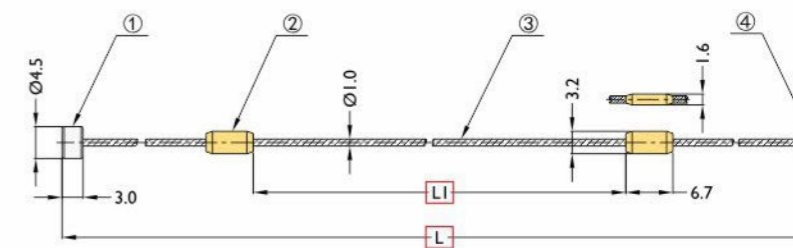

项目编号
Item No.
32401

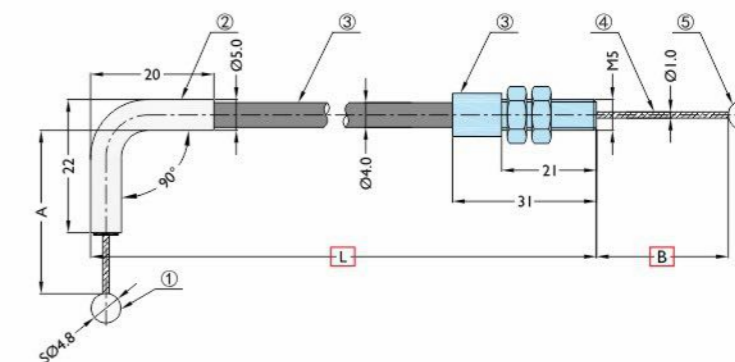

项目编号
Item No.
32502

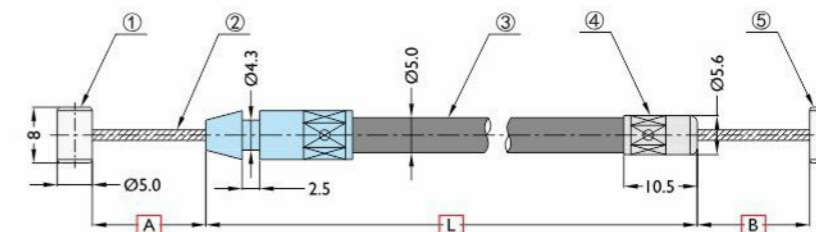

◆ 上面列出的样式为其它顾客座椅底盘控制拉索常用样式，供参考；
◆ L、A、B等参考由顾客根据需求提供；
◆ 如果您需要其它样式，请联系我们技术顾问，我们可以为您定制。

◆ The above cables are the common specs for current customers. Just for reference.
◆ Need customer to give us "L", "A", "B" dimensions.
◆ It can be customized, please just feel free to contact us if you want the different specs.

■ 座椅后仰开关组件(塑料)
■ Motion Furniture Cable Assembly (plastic)

项目编号
Item No.
31501

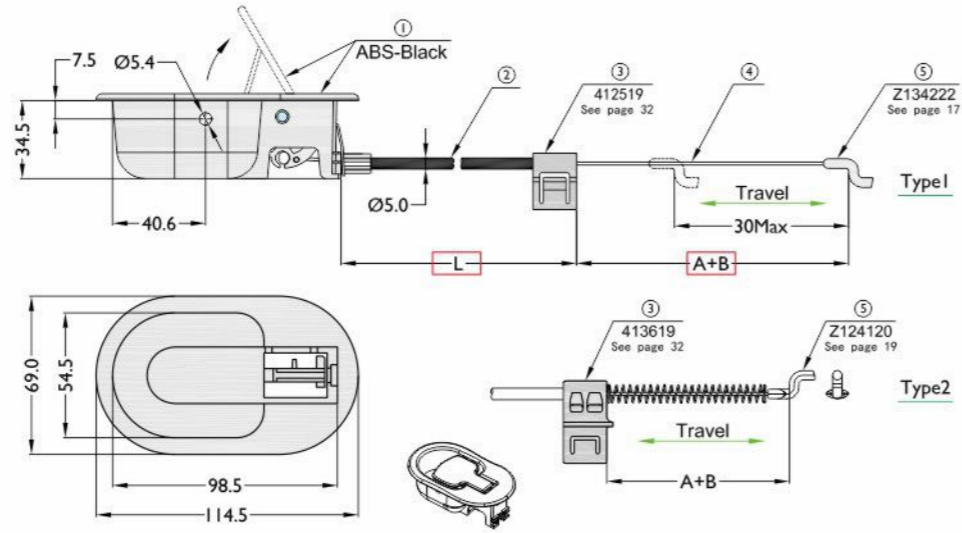
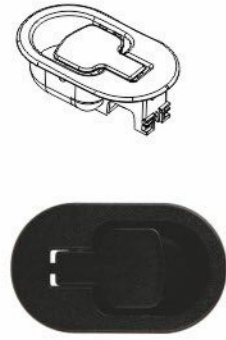

项目编号
Item No.
31502

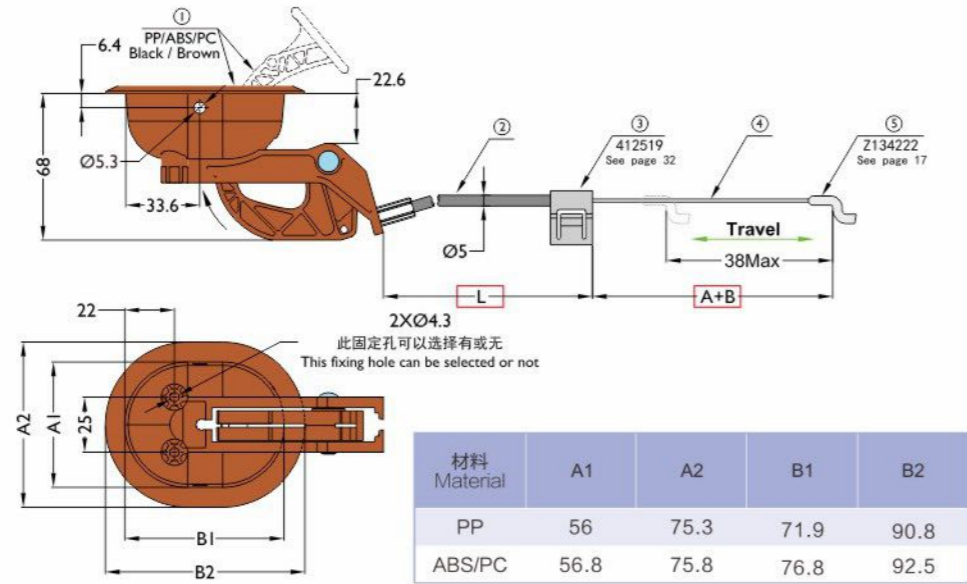

- ◆ "L"和"A+B"参数由顾客根据需求确定;
- ◆ ③⑤详细参数查相对应的项目编号或选择其它相应的零件类型;
- ◆ 如您需要其它类型, 请联系我们技术顾问, 我们可以为您定制.
- ◆ The size of "L" and "A+B" are according to the customers' requirement.
- ◆ Please check the relative item No. for the details of ③⑤.
- ◆ It can be customized, please just feel free to contact us if you want the differ



■ 座椅后仰快关组件 (锌合金)
■ Motion Furniture Cable Assembly (Zinc Alloy)

项目编号
Item No.
31503

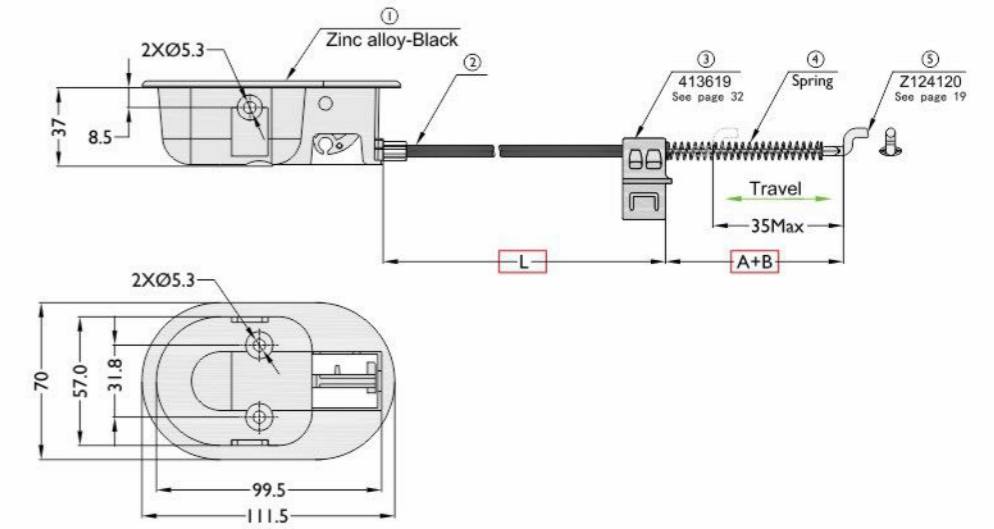
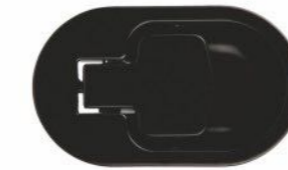

■ 手拉环拉索
■ Motion Furniture Cable Assembly (Hand Ring)

项目编号
Item No.
30501

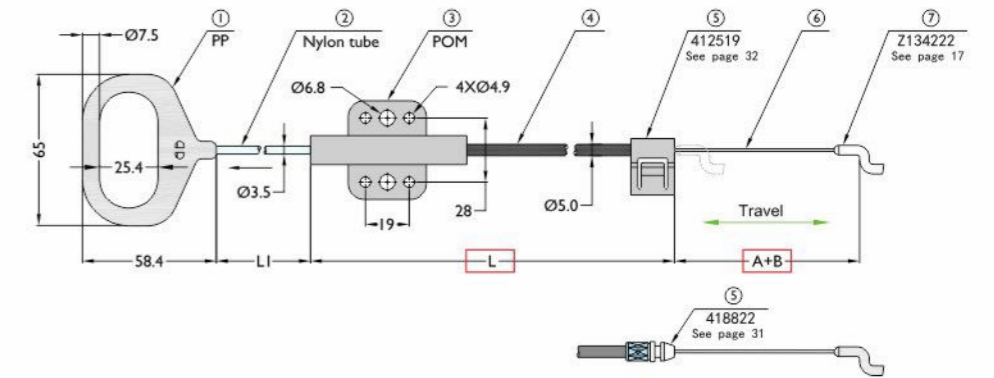

■ 手拉环拉索
■ Motion Furniture Cable Assembly (Hand Ring)

项目编号
Item No.
30502

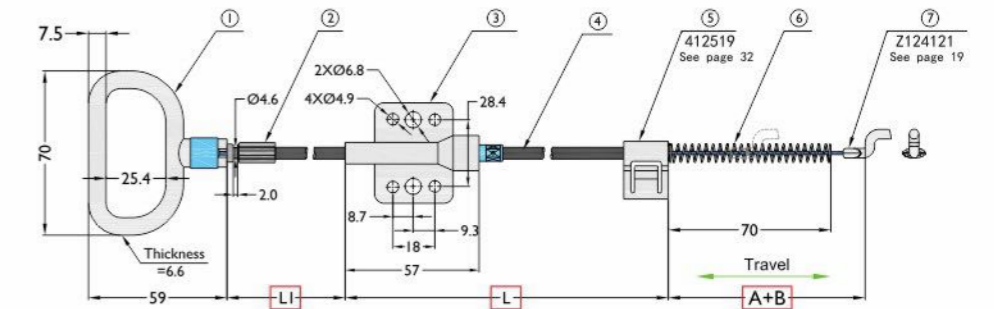

■ 座椅腰靠调节器组件
■ Seat Backrest Adjustment Assembly

项目编号
Item No.
38501

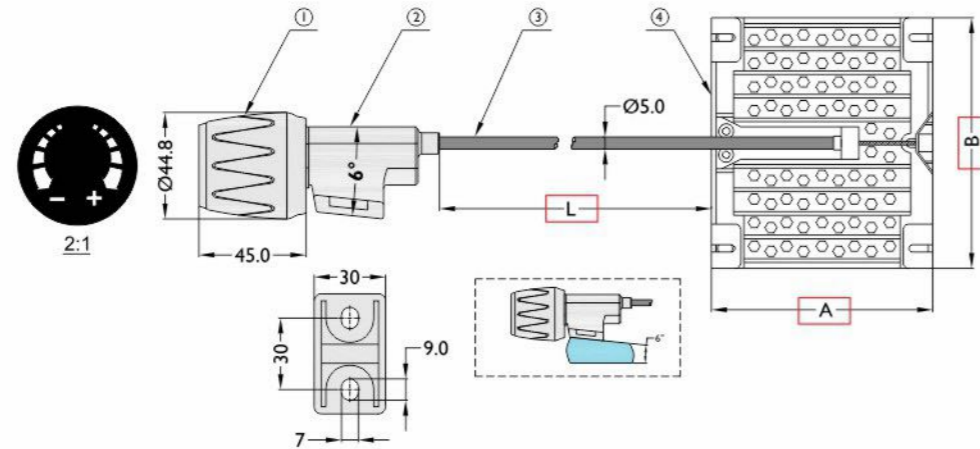

项目编号
Item No.
38502

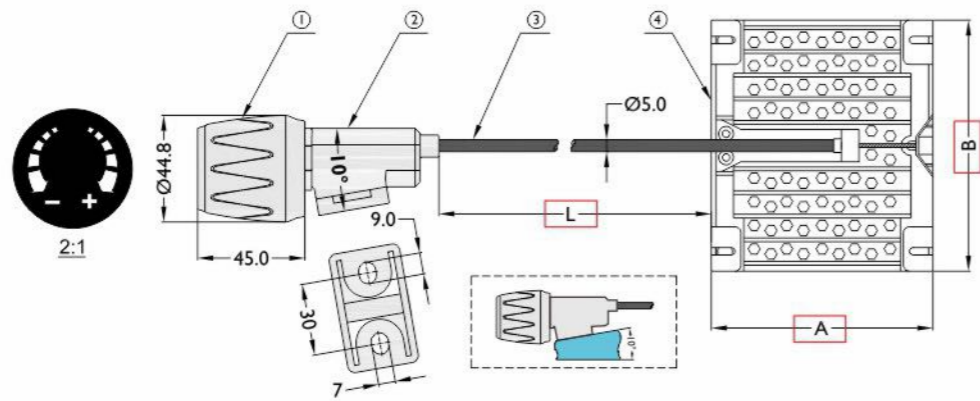

- ◆管长L和4 背靠板规格根据顾客需求提供;
- ◆4 背靠板规格有三种, 具体查看下页明细表;
- ◆1 旋钮颜色有黑色, 烤漆颜色: 闪光银和古沃银, 或者其它颜色;
- ◆38501和38502样式可以根据顾客需求选择调节时“有响声”和“无响声”两种。

- ◆The length of "L" and part 4 are according to customers' requirement.
- ◆There are 3 specs of part 4, please see the details on next page.
- ◆You can choose the color fo part 1.(black,silver and so on)
- ◆You can choose "noise" or "no noise" on 38501 & 38502 type .



项目编号
Item No.
38503

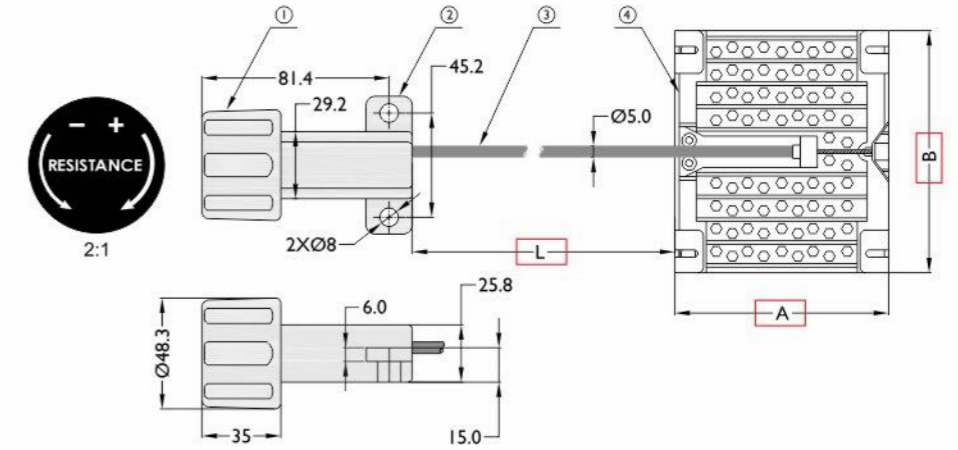

■ 座椅拉索---背靠板
■ Seat Cables---Backrest Support

A mm	B mm	C mm	D mm	H mm	项目编号 Item No.
155	130	106	6.0	55	451613
155	170	145	6.0	55	451716
220	200	176	6.0	70	452220

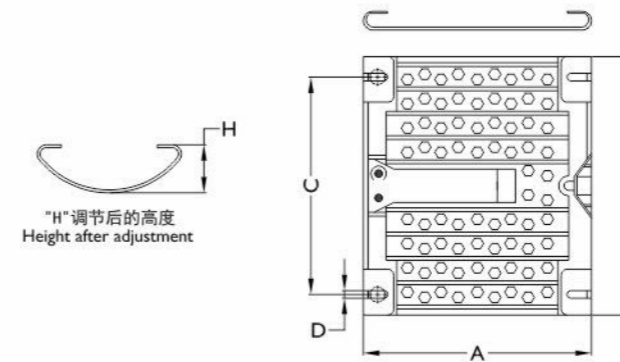

■ 座椅拉索---横条
■ Seat Cables---Crossband

项目编号
Item No.
452355

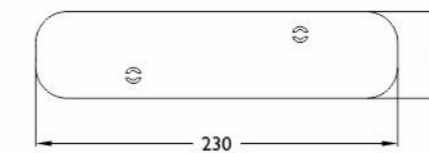

- ◆451716背靠板可以根据客户需求增加横条。
- ◆Customer can choose whether you need crossband or not.

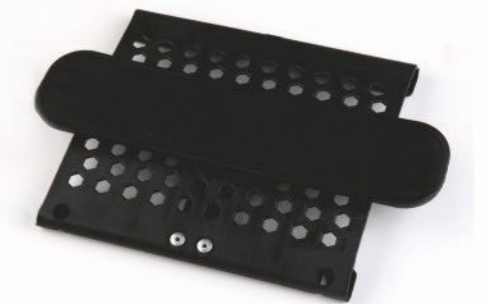

- 一拖二座椅腰靠调节器组件
- Two Seat Backrest Adjuster Assembly

项目编号
Item No.
38504

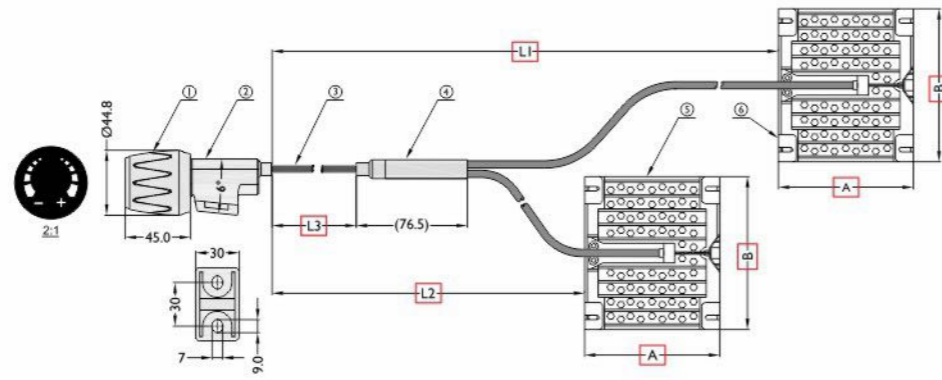

- ◆ 管长L1、L2、L3根据顾客需求确定;
- ◆ ⑤ 背靠板规格根据顾客需求选择。
- ◆ The Length of L1、L2、L3 based on the customers' requirement.
- ◆ There have different size of backrest ⑤ for customer to choose.

- 座椅腰靠调节器组件
- Seat Backrest Adjustment Assembly

项目编号
Item No.
38505

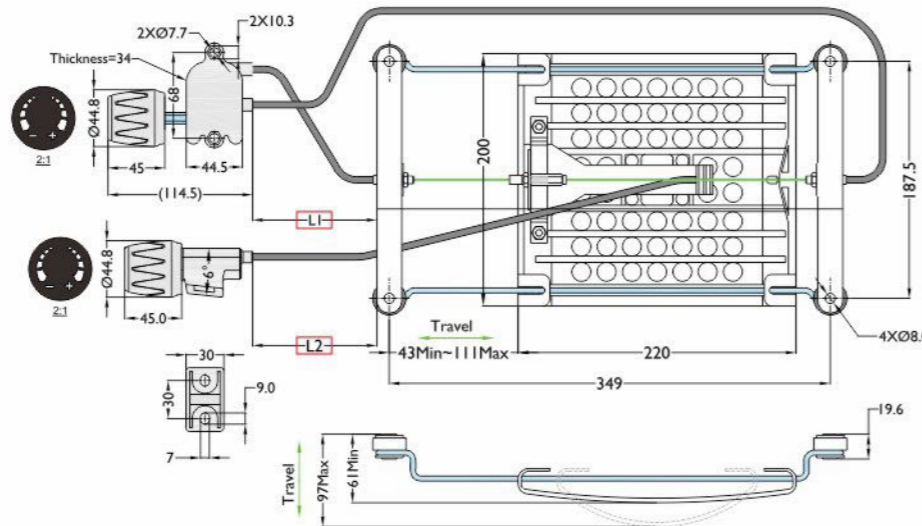

健身器材拉索 Fitness Equipment Cables



- 正反钢索调节器
- Tension Control

项目编号
Item No.
25401

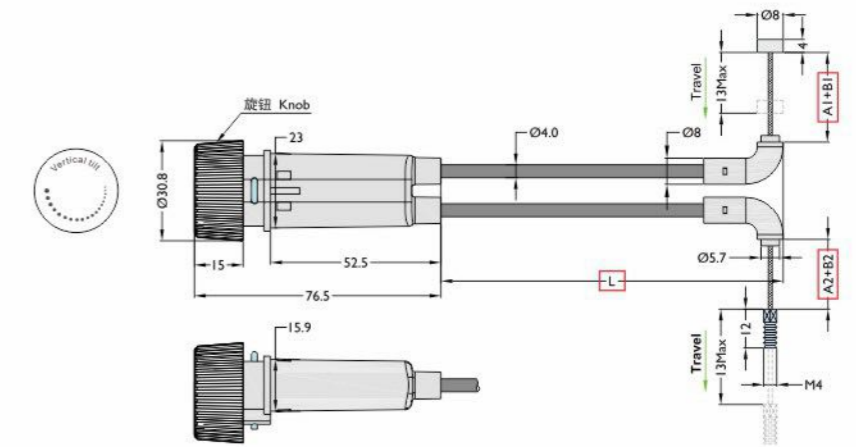

- ◆ "L"、"A1+B1"、"A2+B2"由顾客根据需求确定;
- ◆ 当“旋钮”顺时针旋转时, A1+B1缩短, A2+B2伸长, 最大行程为13mm。
- ◆ "L"、"A1+B1"、"A2+B2" specs are according to customers' requirement.
- ◆ When rotate the "knob", A1+B1 will be short and A2+B2 will be long, the max travel is 13mm.

项目编号
Item No.
52501

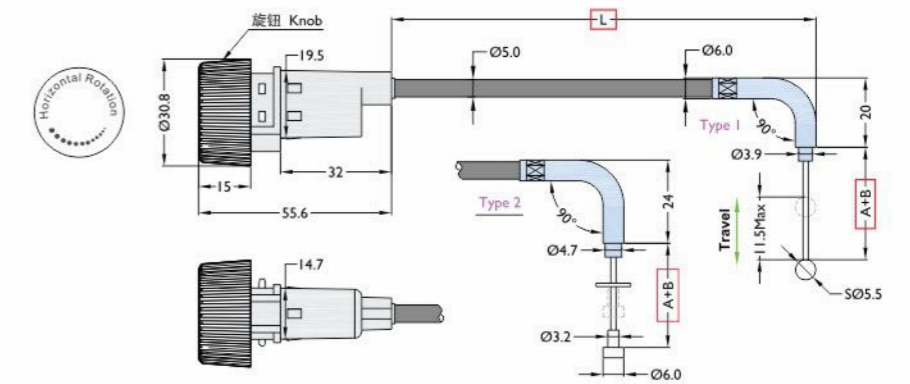

- ◆ "L"、"A+B"由顾客根据需求确定;
- ◆ 顺时针转动旋钮, A+B缩短。
- ◆ "L"、"A+B" specs are according to customers' requirement.
- ◆ Turn the knob clockwise, A+B will be short.

- 无极微调组件
- Tension Control

项目编号
Item No.

52502

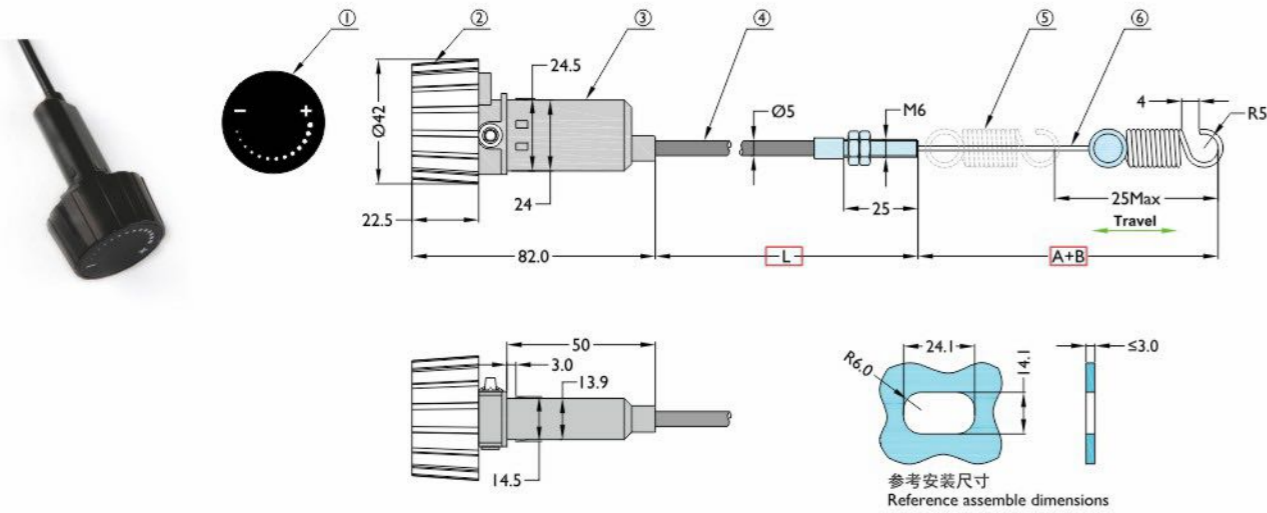

项目编号
Item No.

52503

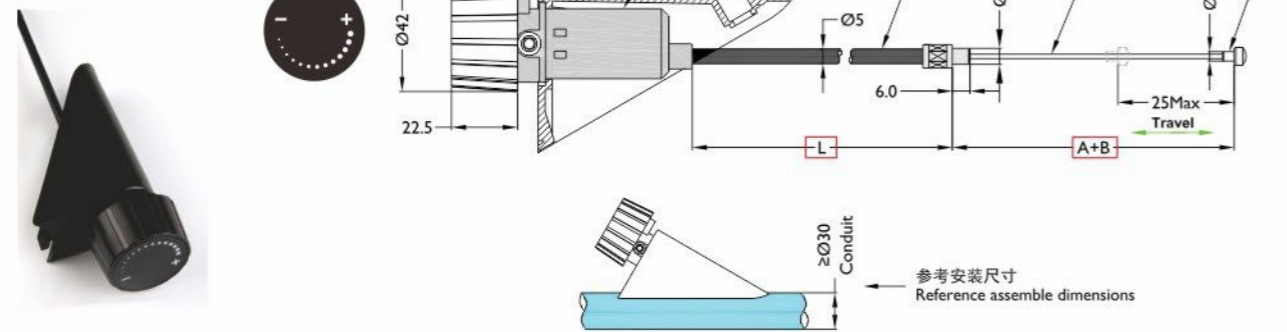

- ◆ "L", "A+B"由顾客根据需求确定;
- ◆ 顺时针转动旋钮“②”时,可以根据需求选择A+B伸长或A+B缩短。

- ◆ "L", "A+B" specs are according to customers' requirement.
- ◆ Turn the knob 2 clockwise, you can choose to elongate or shorten A+B. based on your requirement.

- 八刻度旋钮组件
- Eight Scale Tension Control

项目编号
Item No.

51501

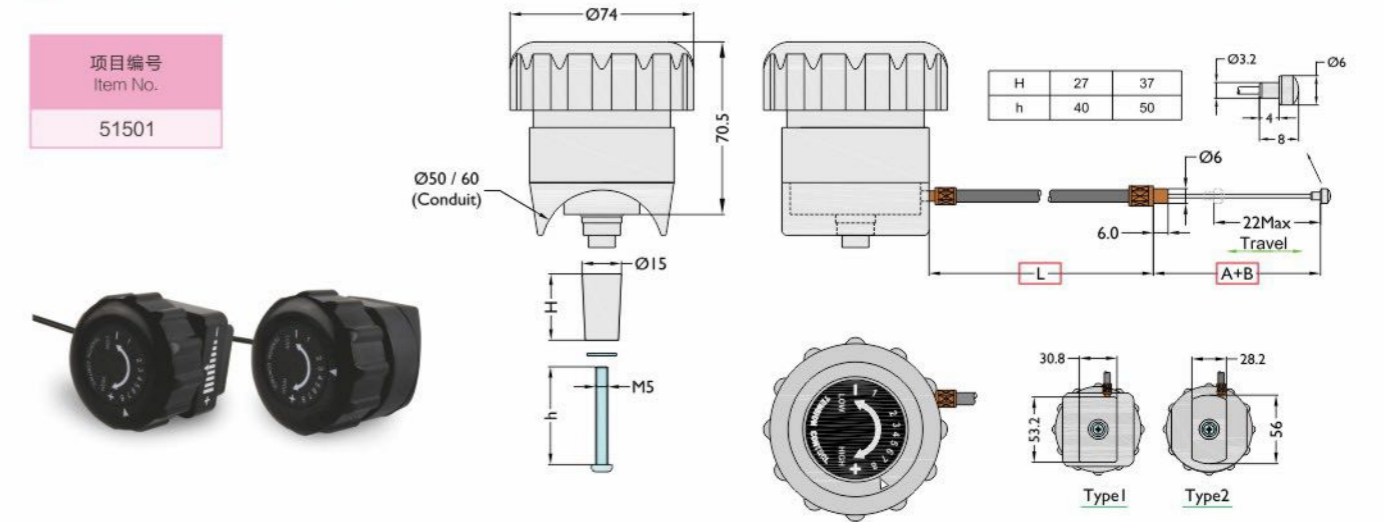

- ◆ 顺时针转动旋钮A+B伸长或缩短, 由顾客根据需求选择;
- ◆ L \ A+B \ H \ h由顾客根据需求选择;
- ◆ 可配 $\text{Ø}50 / \text{Ø}60$ 圆管或方管, 安装孔的尺寸: Type1=(53.7X31.3mm), Type2=(56.4X28.7mm)。

- ◆ Turn the knob clockwise, you can choose to elongate or shorten A+B. based on your requirement.
- ◆ "L", "A+B" "H" "h" specs are according to customers' requirement.
- ◆ Suit for $\text{Ø}50 / \text{Ø}60$ round tube or square tube. Assemble dimension: Type1=(53.7X31.3mm), Type2=(56.4X28.7mm).

项目编号
Item No.

51502

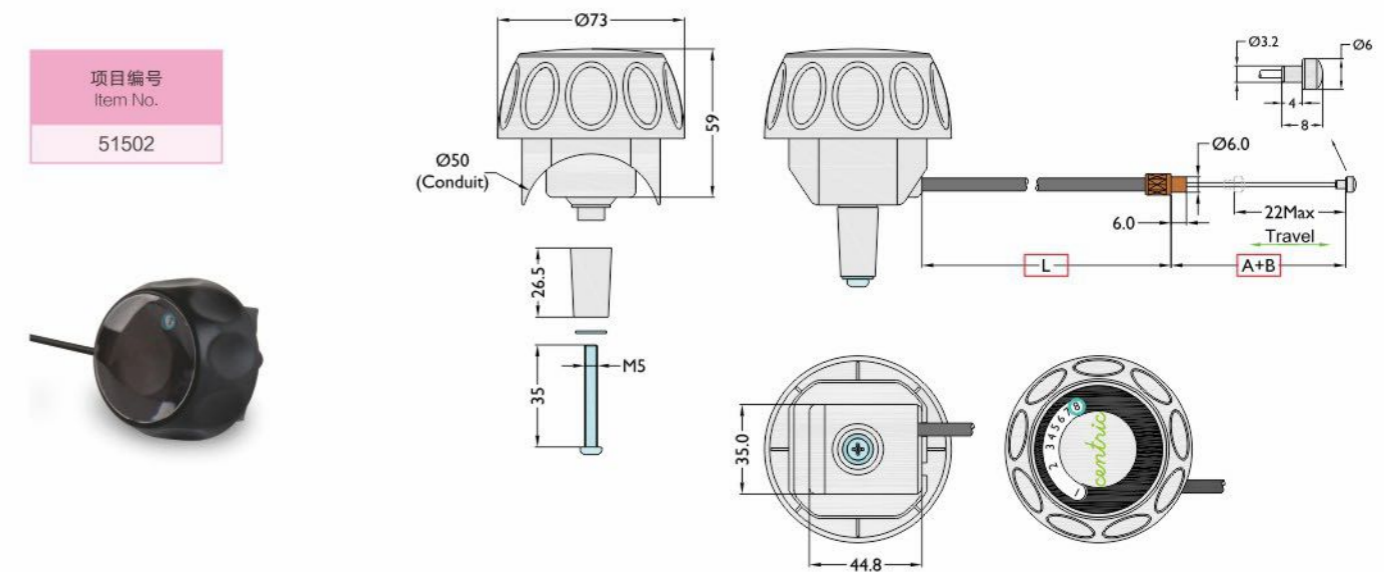

- ◆ 顺时针转动旋钮A+B伸长或缩短, 由顾客根据需求选择;
- ◆ L \ A+B 由顾客根据需求选择;
- ◆ 可配 $\text{Ø}50$ 圆管, 不能配方管, 安装孔尺寸: 45.5*35.5。

- ◆ Turn the knob clockwise, you can choose to elongate or shorten A+B. based on your requirement.
- ◆ "L", "A+B" specs are according to customers' requirement.
- ◆ Suit for $\text{Ø}50$ round tube, it's unsuitable for square tube. Assemble dimension: 45.5*35.5.

■ 连接线
■ Steel Connect Cable

项目编号
Item No.
53501

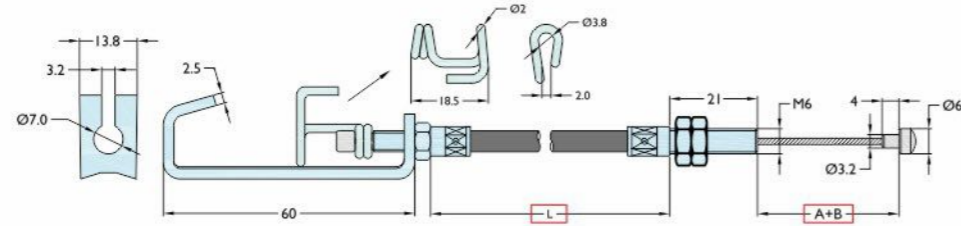

项目编号
Item No.
53502

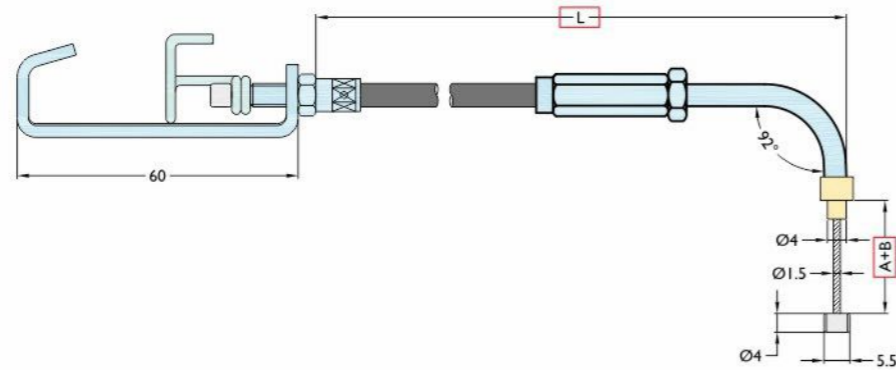

■ 马达拉线
■ Motor Cable

项目编号
Item No.
56501

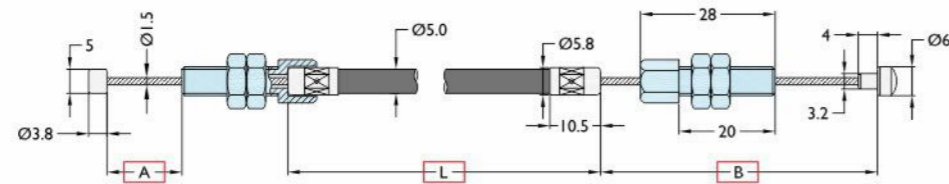

园林机械拉索
Outdoor Power
Equipment Controls



■ 制动拉索
■ Brake Cable

项目编号
Item No.
22251

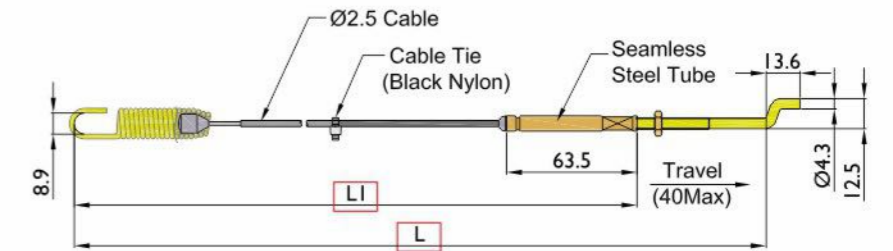

项目编号
Item No.
22252

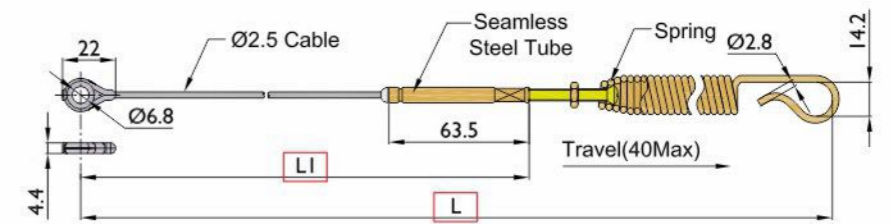

项目编号
Item No.
22253

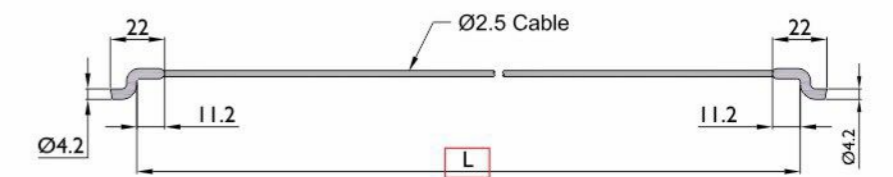

- ◆ ϕ 2.5包胶钢丝绳;
- ◆ 无缝钢管是可旋转的;
- ◆ L/L1值,根据客户的要求提供。
- ◆ ϕ 2.5 coated wire rope.
- ◆ Seamless steel tube is rotatable.
- ◆ L & L1 specs are according to customers' requirement.

■ 割草机油门线
■ Throttle Cables

项目编号
Item No.
21421

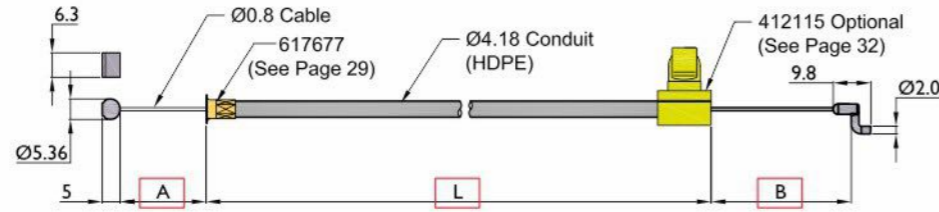

项目编号
Item No.
21422

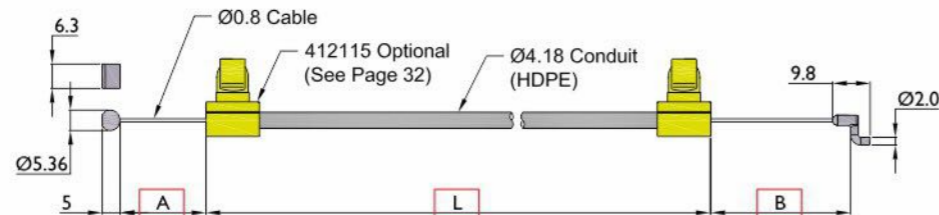

项目编号
Item No.
21423

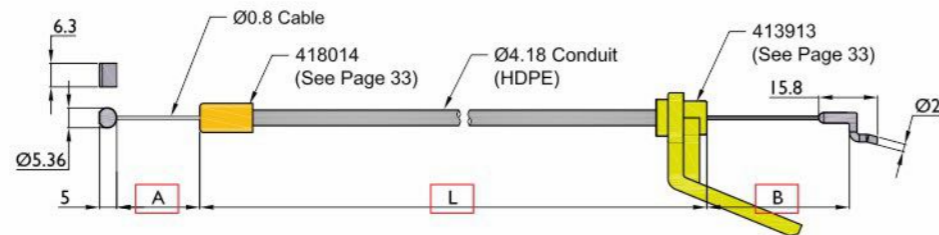

项目编号
Item No.
21424

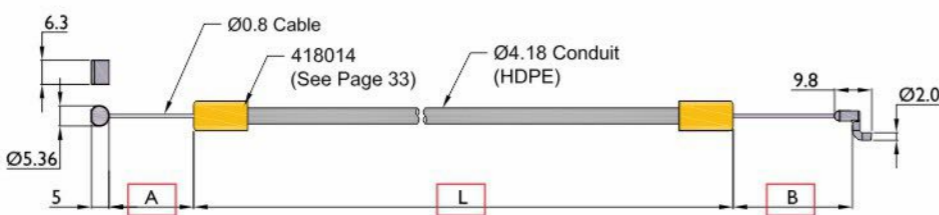

- ◆ 套管为 ϕ 4.18, 单层HDPE胶管;
- ◆ LVA+B值, 根据客户的要求提供;
- ◆ 套管末端配件根据提供的页码可以查看零件详细规格和其他类似规格零件。
- ◆ Conduit specs is ϕ 4.18 single-layer.
- ◆ L & A+B specs are according to customers' requirement.
- ◆ You can check the accessories details from page 28-36.

■ 园林拉索
■ Outer Power Equipment Cables

项目编号
Item No.
27581

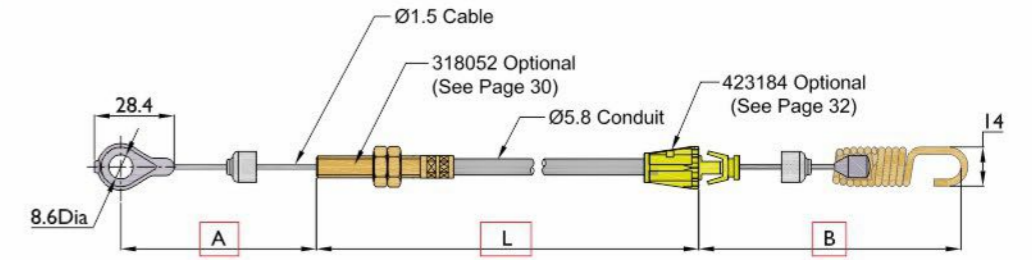

项目编号
Item No.
27582

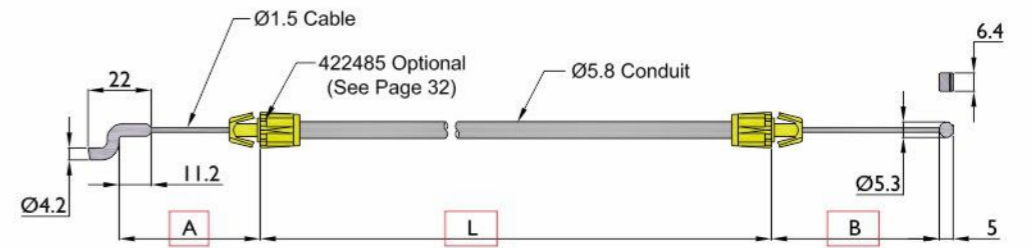

项目编号
Item No.
27583

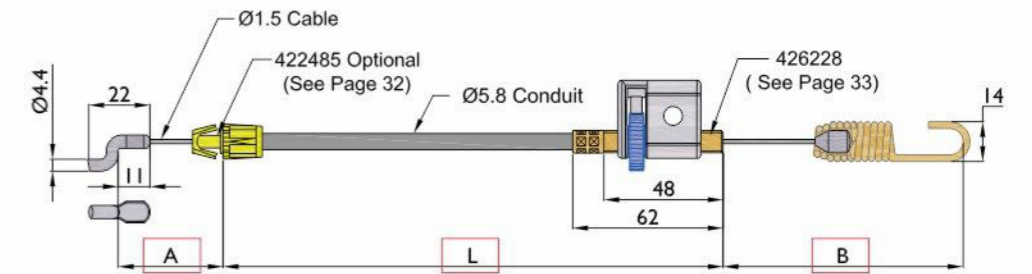

- ◆ 套管为 ϕ 5.8圆丝管;
- ◆ LVA+B值, 根据客户的要求提供;
- ◆ 套管末端配件根据提供的页码可以查看零件详细规格和其他类似规格零件。
- ◆ Conduit specs is ϕ 5.8 round wire conduit.
- ◆ L & A+B specs are according to customers' requirement.
- ◆ You can check the accessories details from page 28-36.

■ 弹簧离合线
■ Clutch Cables With Spring

项目编号
Item No.
23581

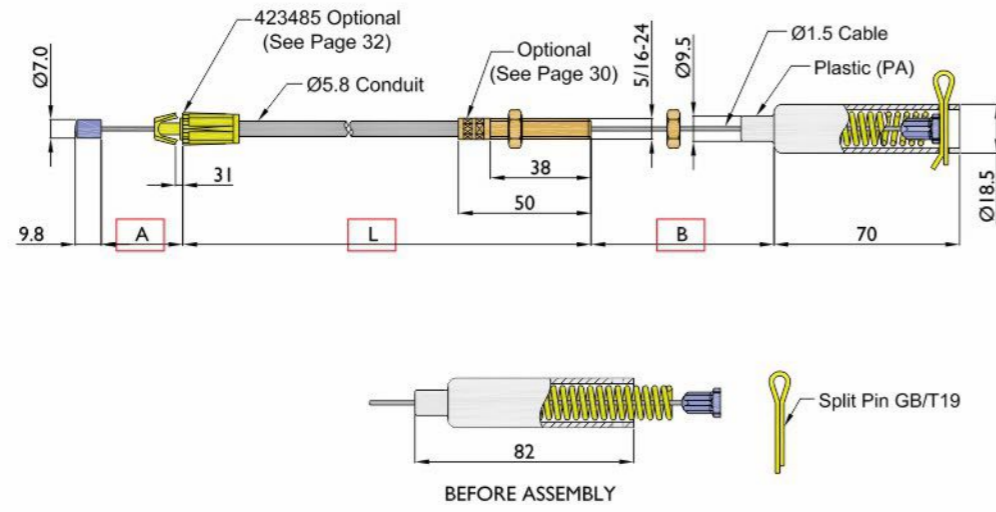

项目编号
Item No.
23582

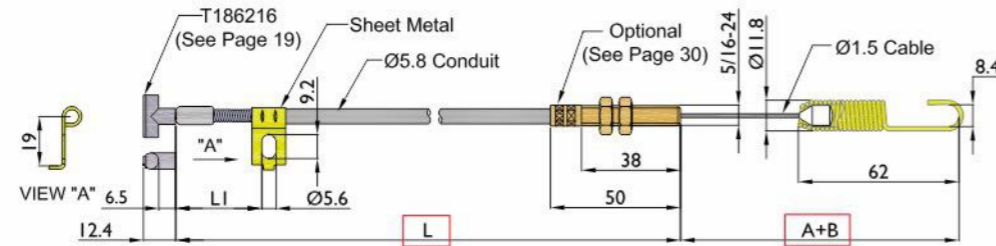

- ◆ ϕ 5.8圆丝管;
- ◆ LVA+B值, 根据客户的要求提供;
- ◆ 套管末端配件根据提供的页码可以查看零件详细规格和其他类似规格零件。
- ◆ Conduit specs is ϕ 5.8 round wire conduit.
- ◆ L & A+B specs are according to customers' requirement.
- ◆ You can check the accessories details from page 28-36.

■ 草坪机拉索
■ Control Cable For Garden Machine

项目编号
Item No.
24581

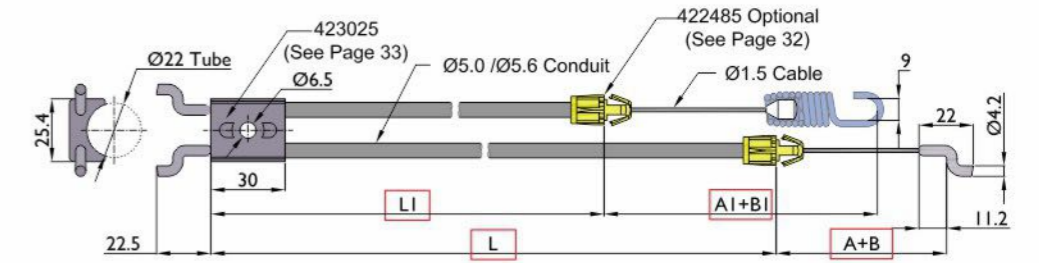

项目编号
Item No.
24582

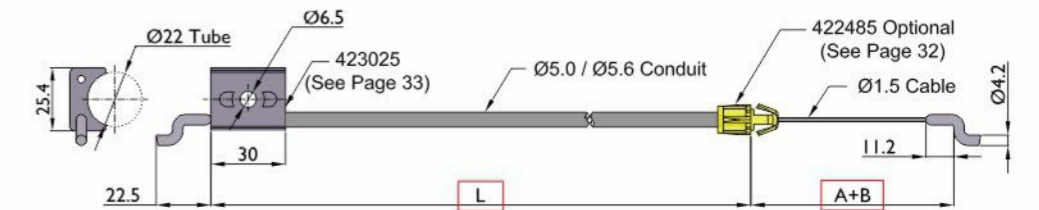

- ◆ ϕ 5.0 \ \phi 5.6平行丝管;
- ◆ L/L1A+B/A1+B1值, 根据客户的要求提供;
- ◆ 可配 ϕ 22圆形管。
- ◆ Conduit is 5.0 or 5.6 double wire conduit.
- ◆ L & L1 & A+B & A1+B1 specs are according to customers' requirement.
- ◆ It's suitable for ϕ 22 round tube.

项目编号
Item No.
23583

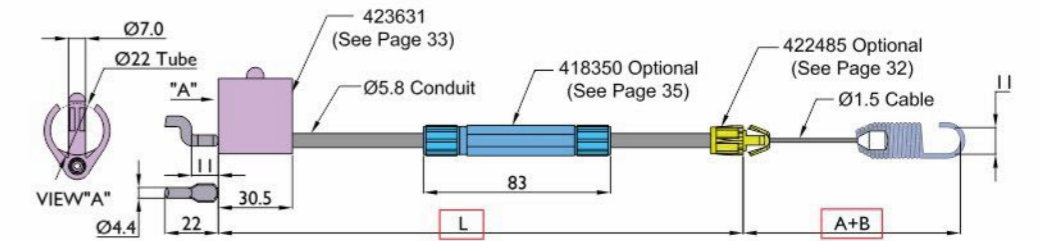

- ◆ ϕ 5.8圆丝管套管;
- ◆ LVA+B值, 根据客户的要求提供;
- ◆ 可配 ϕ 22圆形管。
- ◆ Conduit specs is ϕ 5.8 round wire conduit.
- ◆ L & A+B specs are according to customers' requirement.
- ◆ It's suitable for ϕ 22 round tube.

■ 冲压支座油门线
■ Throttle Cables

项目编号
Item No.
29581

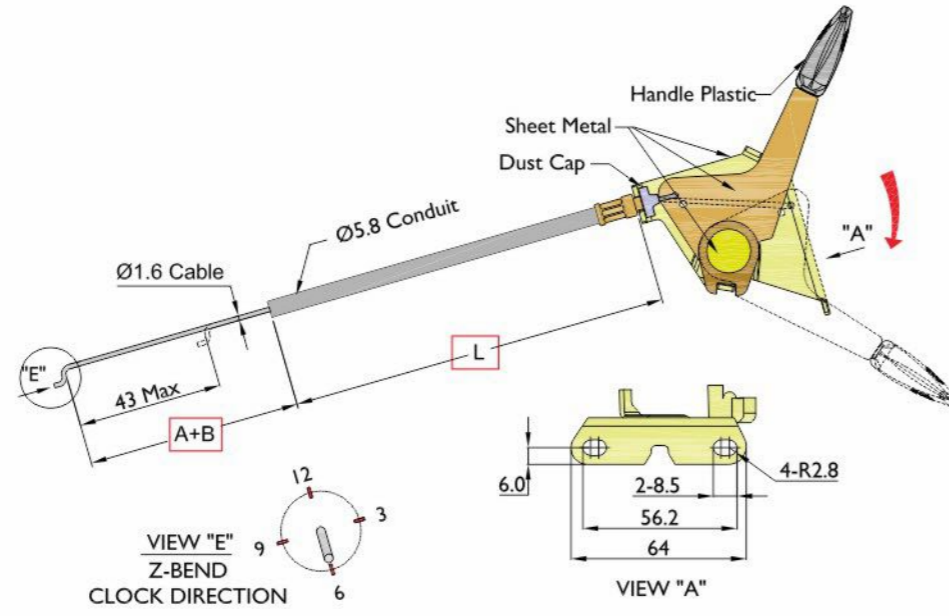

■ 冲压支座油门线
■ Throttle Cables

项目编号
Item No.
29583

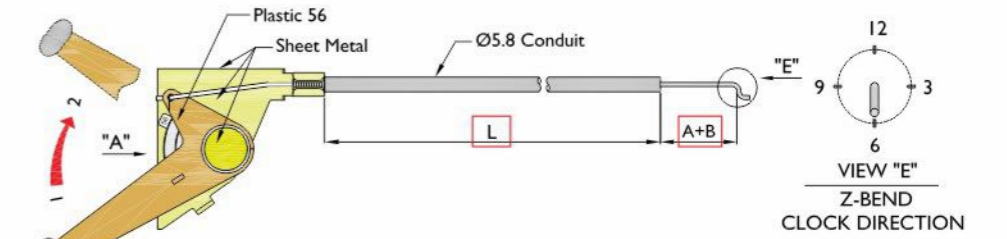

塑胶件 Plastic	行程规格 Travel (mm)		类型 Type
	F	G	
37	30	/	TYPE I
45	26.5	/	TYPE I
56	31.5	/	TYPE I
88	8	31	TYPE II

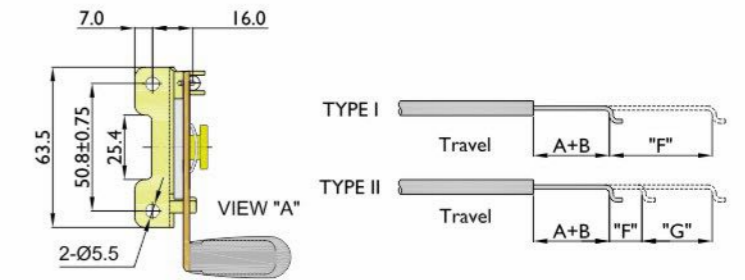

项目编号
Item No.
29582

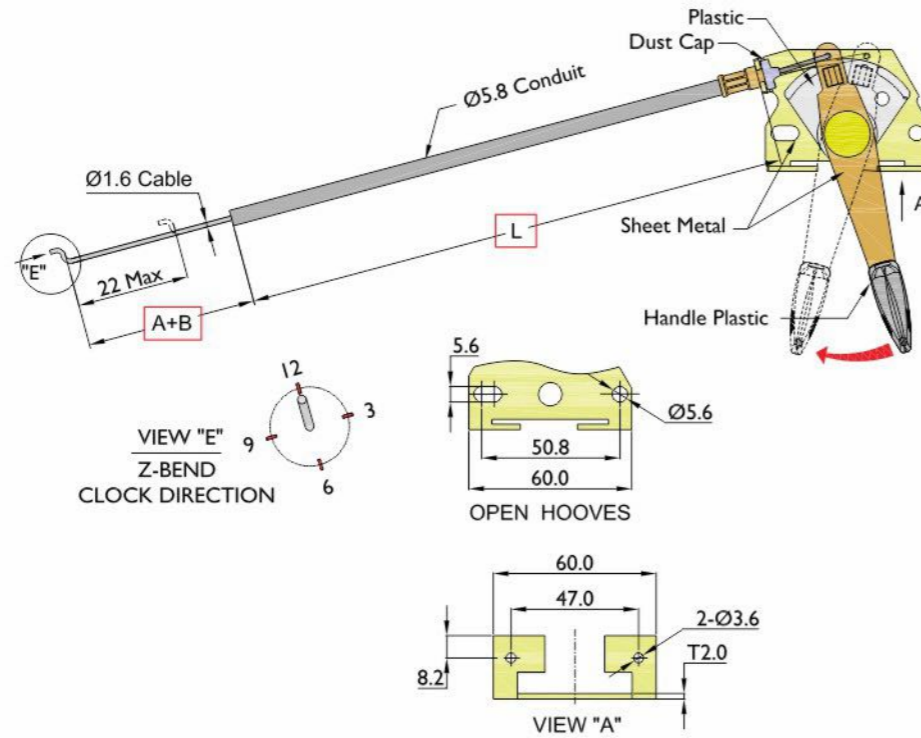

项目编号
Item No.
29584

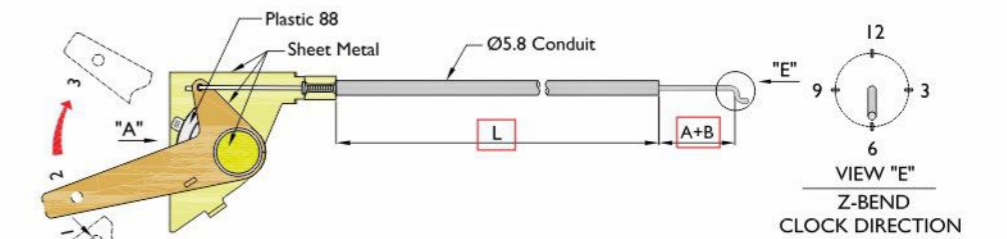

塑胶件 Plastic	行程规格 Travel (mm)		类型 Type
	F	G	
37	30	/	TYPE I
45	26.5	/	TYPE I
56	31.5	/	TYPE I
88	8	31	TYPE II

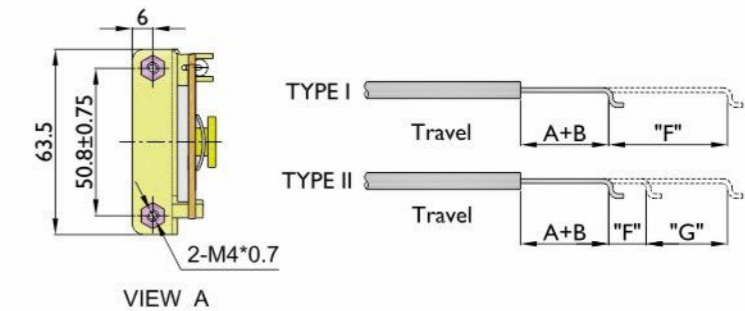

- ◆ 内线为不锈钢直钢丝;
- ◆ Z形钩折弯方向, 由顾客根据需求按照钟表面图选择;
- ◆ L/A+B/Travel值, 根据客户的要求提供。

- ◆ The inner wire material is stainless steel.
- ◆ Z end direction & specs are according to our customers' requirement.
- ◆ L & A+B & Travel specs are according to customers' requirement.

- ◆ 内线为不锈钢直钢丝;
- ◆ Z形钩折弯方向, 由顾客根据需求按照钟表面图选择;
- ◆ 调节行程, 由顾客根据需求按照行程表选择;
- ◆ L/A+B/Travel值, 根据客户的要求提供。

- ◆ The inner wire material is stainless steel.
- ◆ Z end direction & specs are according to our customers' requirement.
- ◆ Choose the travel specs according to the travel list above.
- ◆ L & A+B & Travel specs are according to customers' requirement.

阻风门拉线
Choke Cable

项目编号
Item No.
28581

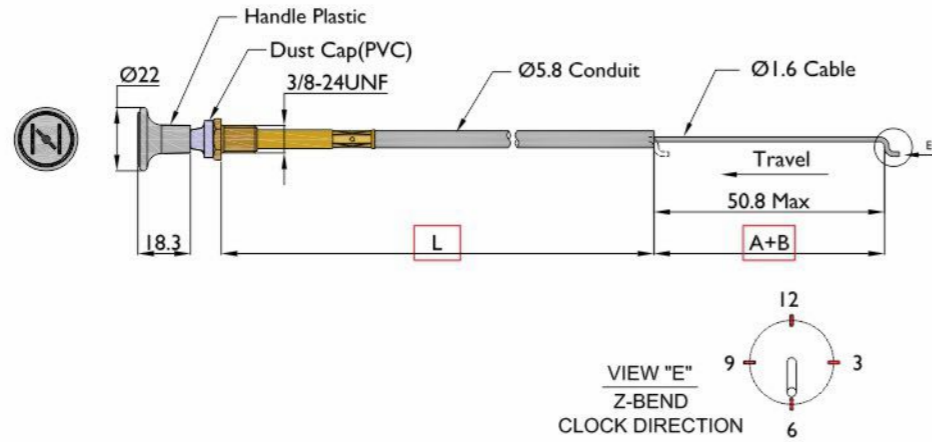

项目编号
Item No.
28601

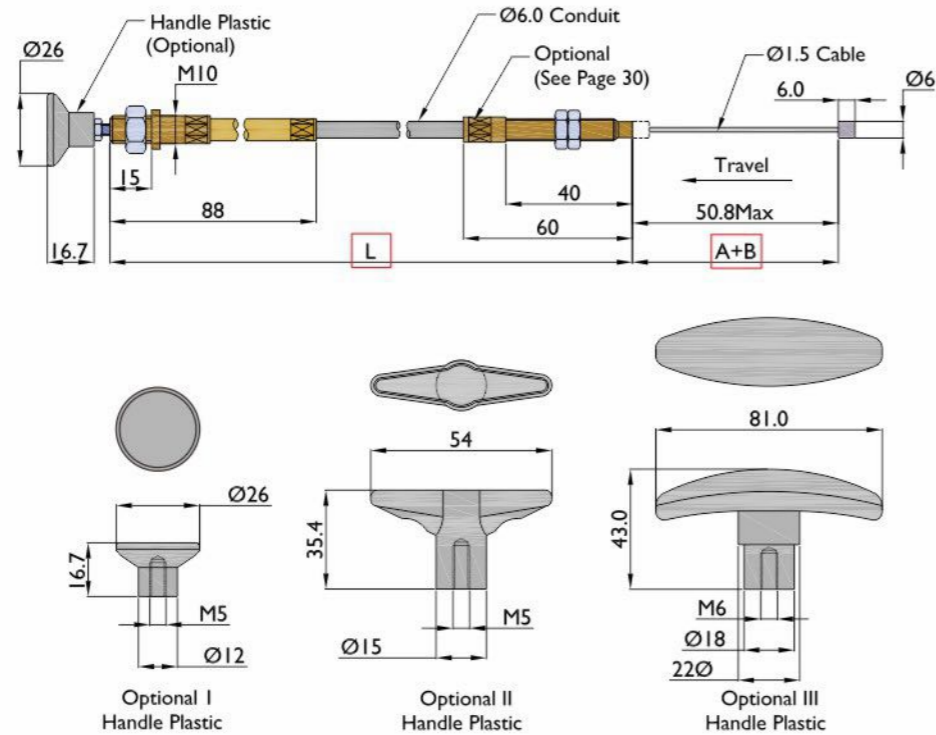

- ◆ 客户可以选择不同形状的手柄;
- ◆ LVA+B值, 根据客户的要求提供。
- ◆ Customer can choose different handles.
- ◆ L & A+B specs are according to customers' requirement.

变档开关线
Throttle Cables

项目编号
Item No.
29051

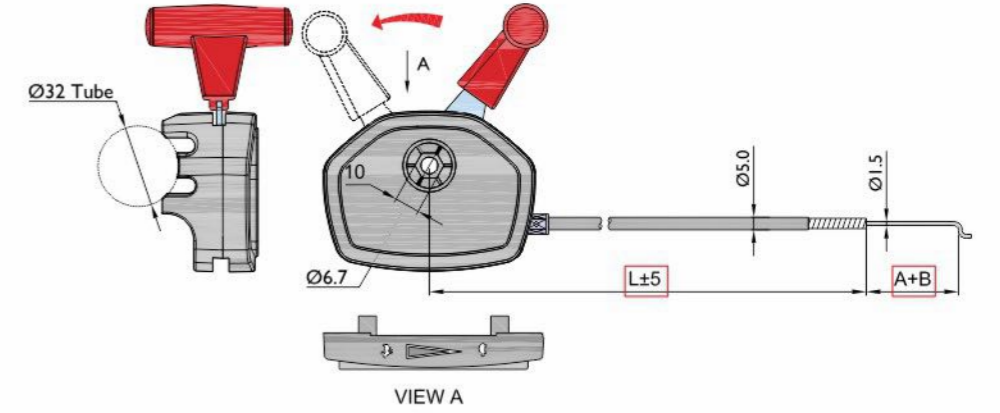

塑胶件 Plastic	行程规格 Travel (mm)		类型 Type
	F	G	
37	30	/	TYPE I
45	26.5	/	TYPE I
56	31.5	/	TYPE I
88	8	31	TYPE II

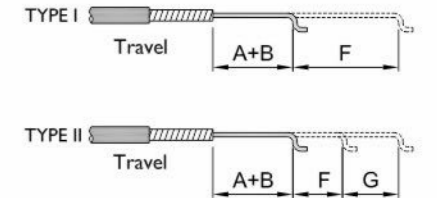
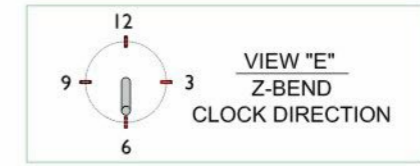

项目编号
Item No.
29052

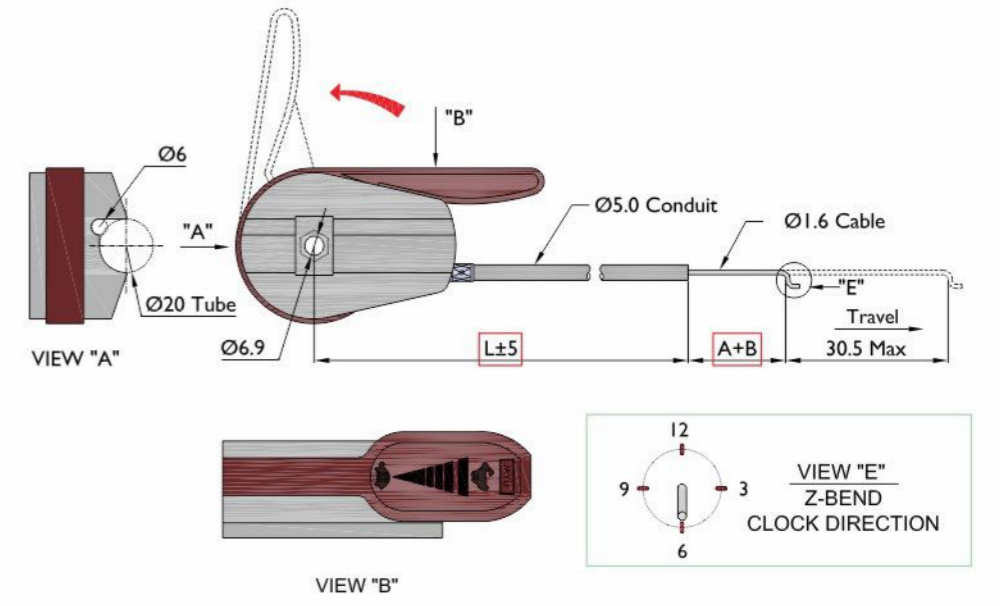

- ◆ 内线为不锈钢直钢丝;
- ◆ Z形钩折弯方向, 由顾客根据需求按照钟表图选择;
- ◆ 调节行程, 由顾客根据需求按照行程表选择;
- ◆ LVA+B\Travel值, 根据客户的要求提供;
- ◆ 可配ø32或者ø20圆形管。
- ◆ The inner wire material is stainless steel.
- ◆ Z end direction & specs are according to our customers' requirement.
- ◆ Choose the travel specs according to the travel list above.
- ◆ L & A+B & Travel specs are according to customers' requirement.
- ◆ It's suitable for ø 32 or ø 20 round tube.

换挡开关线
Shift Cable

项目编号
Item No.
19051

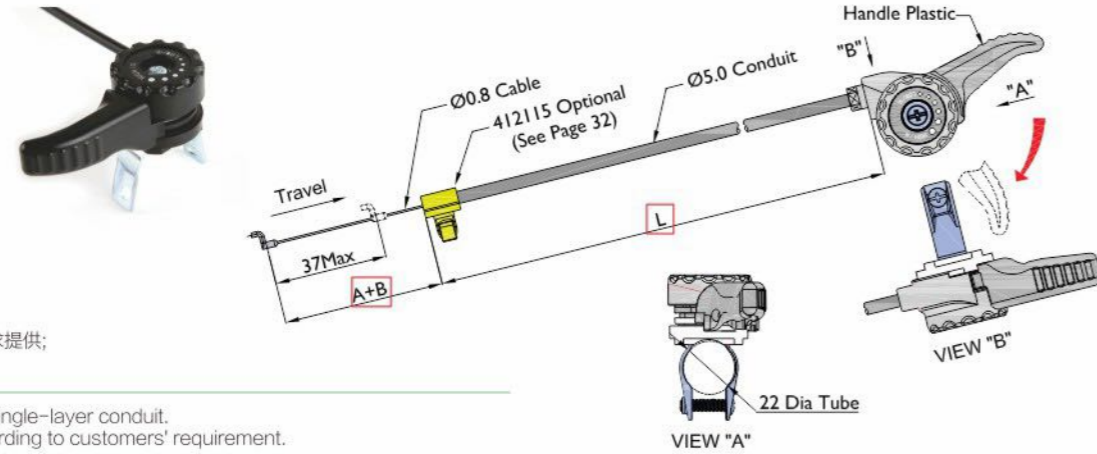

- ◆ Ø 5 PP单层胶管;
- ◆ LVA+B值, 根据客户的要求提供;
- ◆ 可配Ø22圆形管。
- ◆ Conduit specs is Ø 5.0 single-layer conduit.
- ◆ L & A+B specs are according to customers' requirement.
- ◆ It's suitable for Ø 22 round tube.

刹车线
Brake Cables

项目编号
Item No.
25101

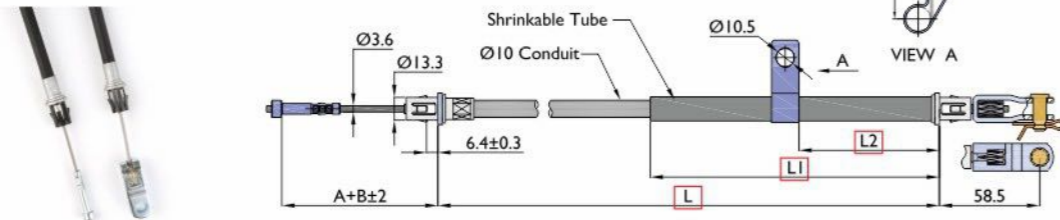

项目编号
Item No.
25102

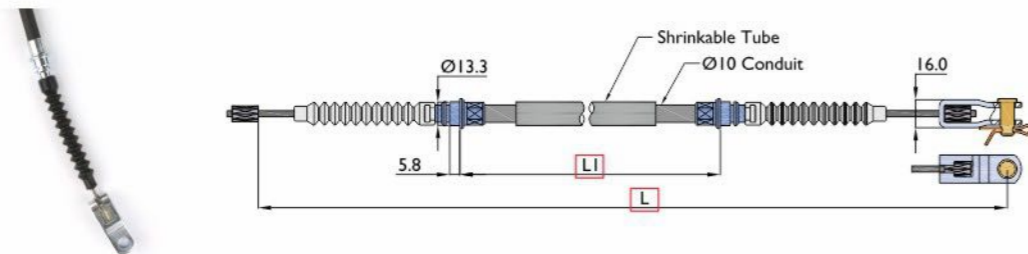

项目编号
Item No.
25103

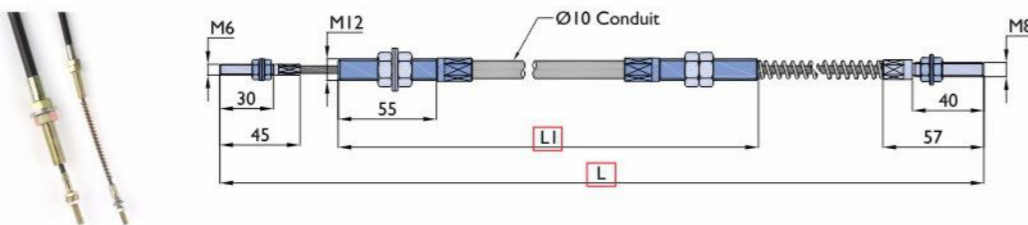

- ◆ 套管为10mm扁丝管 (含内衬管);
- ◆ L \ L1 \ L2 \ A+B值, 根据客户的要求提供。
- ◆ Conduit specs is Ø10 flat wire conduit (include inner tube).
- ◆ L & L1 & L2 & A+B specs are according to customers' requirement.

推拉索
Push Pull Cables

项目编号
Item No.
27641

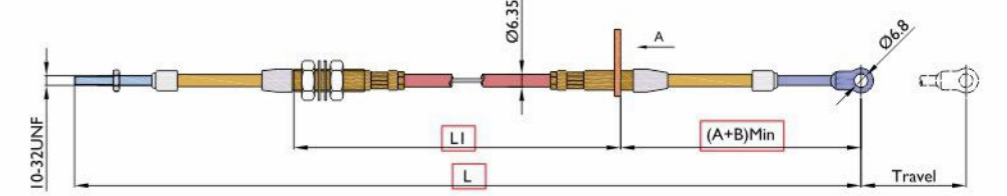

项目编号
Item No.
27951

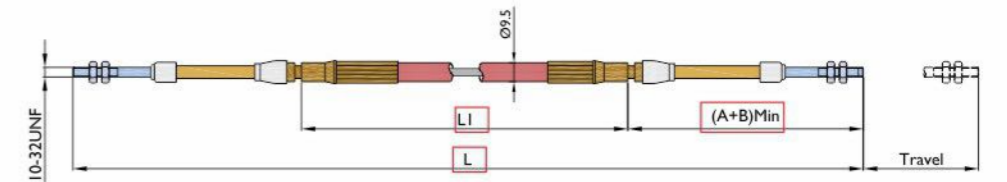

项目编号
Item No.
27101

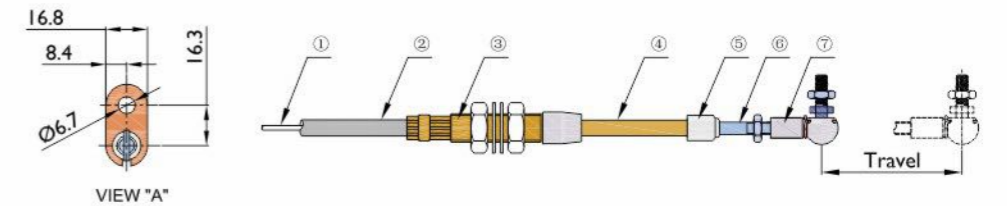
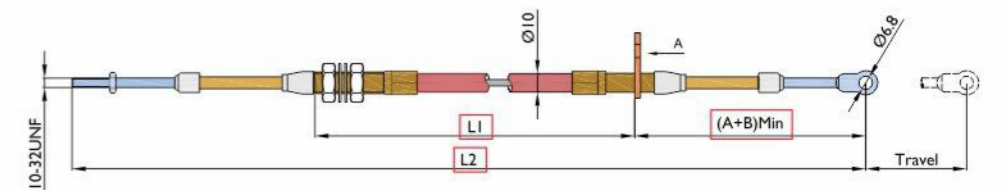

系列号 Serial NO.	套管外径 Conduit OD (mm)	类型Type*3"					调节行程 Travel(mm)	钢丝绳外径 Wire OD (mm)	工作负载 (N) 推力拉力 Working Load (N) Push/Pull	最小弯曲半径 Min Bend Radii (mm)
		I	II	III	IV	V				
2764	Ø6.35	√	-	-	-	-	50	Ø1.8	200/1500	R≥250
		√	-	-	-	-	76			
		-	√	-	-	-	85			
		-	√	-	-	-	110			
2795	Ø9.5	-	-	√	-	-	50	Ø3.2	300/1000	R≥350
		-	-	√	-	-	76			
2710	Ø10	-	-	-	√	√	50	Ø3.6	300/1000	R≥400
		-	-	-	√	√	76			

- ◆ 套管为Ø6.35\Ø9.5\Ø10直丝管;
- ◆ L\L1\ (A+B)\min\Travel值, 根据客户的要求提供。
- ◆ Conduit specs is Ø 6.35 or Ø 9.5 or Ø 10 straight wire conduit.
- ◆ L & L1 & (A+B)\min & Travel specs are according to customers' requirement.



汽车拉索主要用于制动、换挡、空调、座椅、门锁、后视镜等。

Automobile cables are mainly used for control functions, such as braking, shift and also for chair, lock, rearview mirror etc.

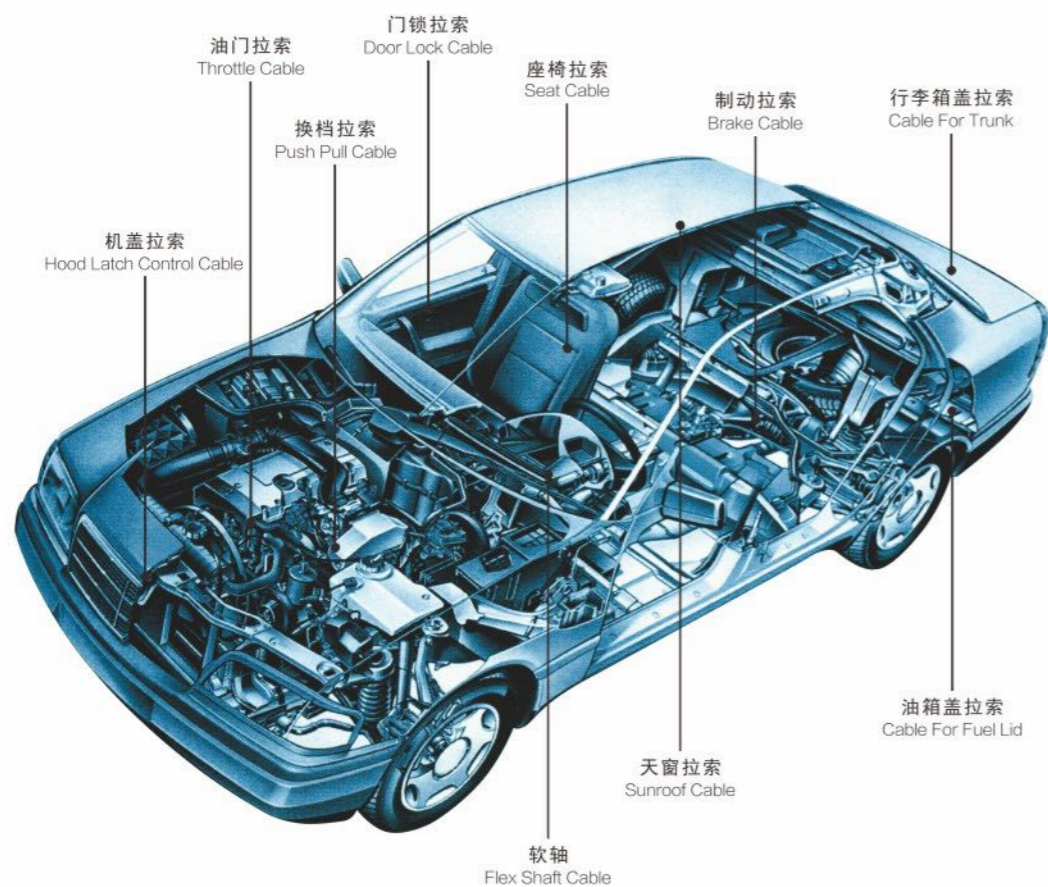



座椅调节线主要用于座椅升降，后仰等控制，结构简单，操作方便，广泛用于办公椅，按摩椅及汽车座椅。

The primary function of seat cable is to control the height and back angle of seats. The structure is simple and easy to use. Our cables are widely used in office chairs, massage chairs and car seats etc.





园林机械油门线，品种齐全，产量大，品质优。

Our company has a comparative advantage in the production of cables for outdoor power equipment. High volume and perfect quality.

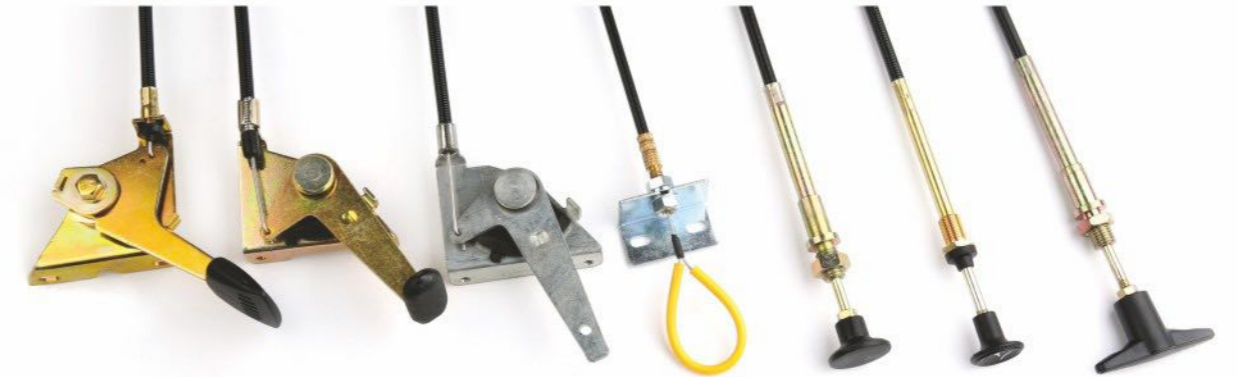



卫浴洁具拉索主要用于面盆，浴缸，马桶等排水用，操作方便。

Sanitary equipment cables are mainly used in sinks, bathtubs and toilet bowls for purposes of flushing. It's easy to use.

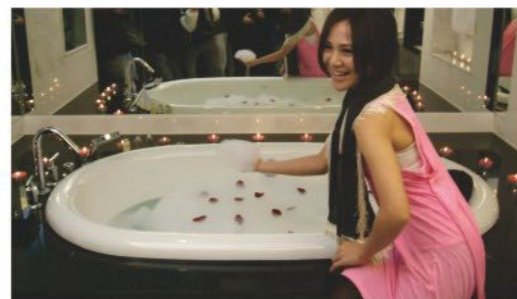
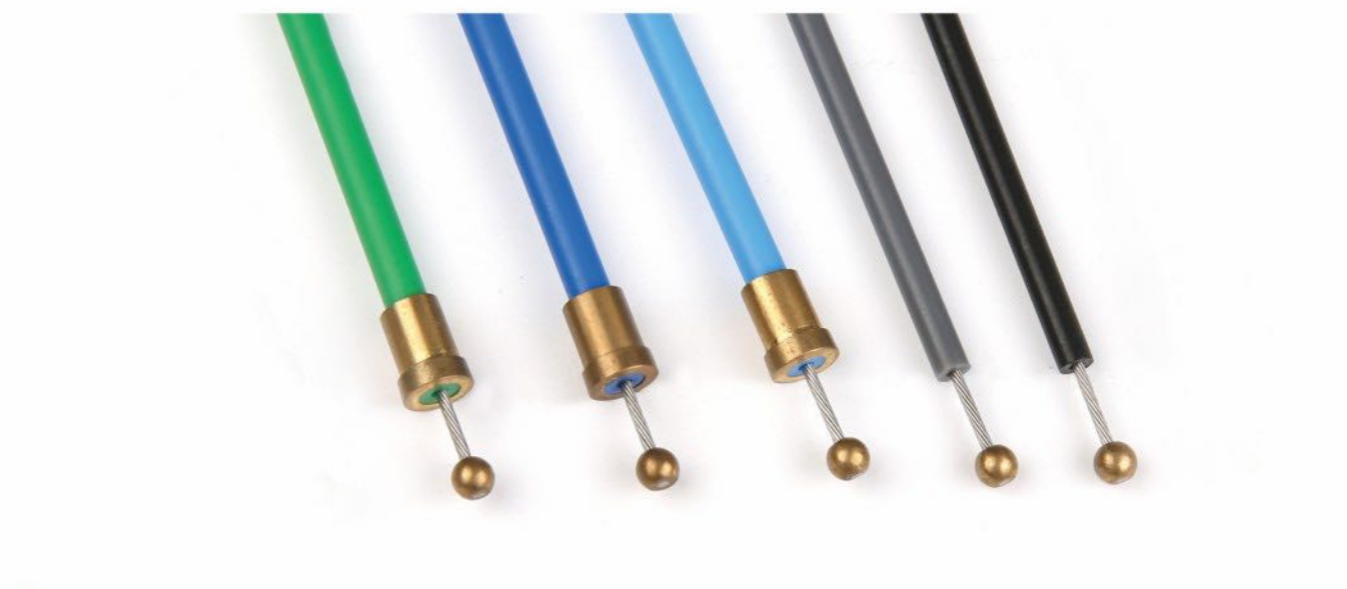

童车拉索 Pram Cables



童车拉索主要用于收车，刹车等控制，结构简便。

Pram cables are mainly used for control functions, such as braking and storage. The structure is simple.





其他拉索\软轴
Other Cables &
Flexible Shaft

用于：丝印机、电梯、医疗器材、圈闸门、消毒机、玩具、搅拌机、高尔夫球车、叉车、船舶、工程机械等。

Using for: Silk machinery, elevator, medical equipments, circle strobe, sterilizing machine, toy, mixer, golf vehicle, forklift, vessel, construction machinery and so on.





各类钢索: 安全绳、灯饰吊绳、绳夹扣。

Steel Cable: Safety Cable, Lighting Cable, Clips.

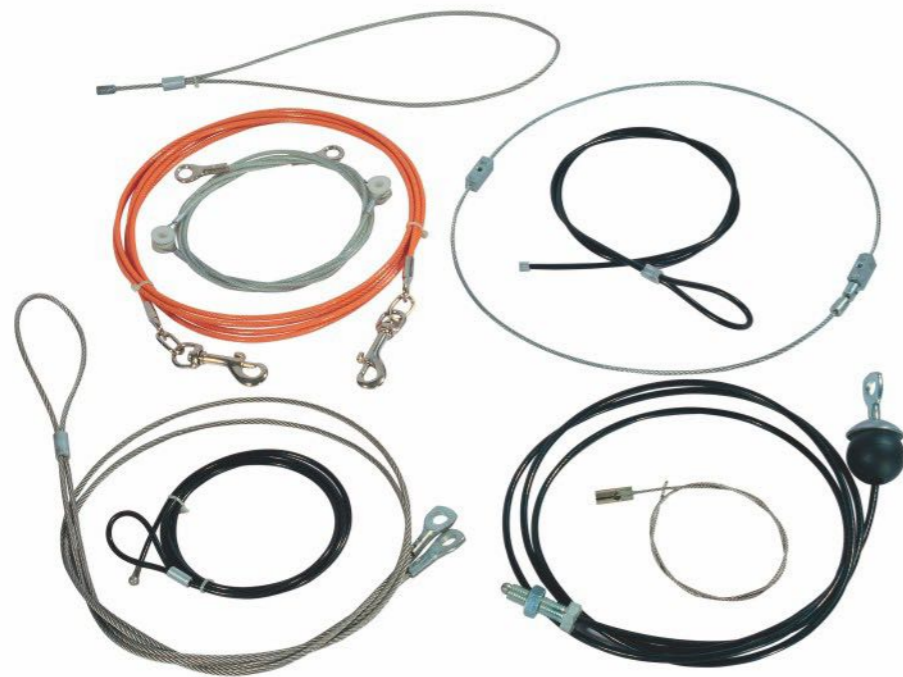

五金塑料配件 Hardware & Rubber Accessories



自动车床件、冲压件、压铸件、注塑件、橡胶件。

Automatic Lathe Parts, Stamping Parts, Die Casting Parts, Injection Parts, Rubber Parts.

产品选型指引 Product Selection Guidelines

常用拉索结构 Ordinary Structure

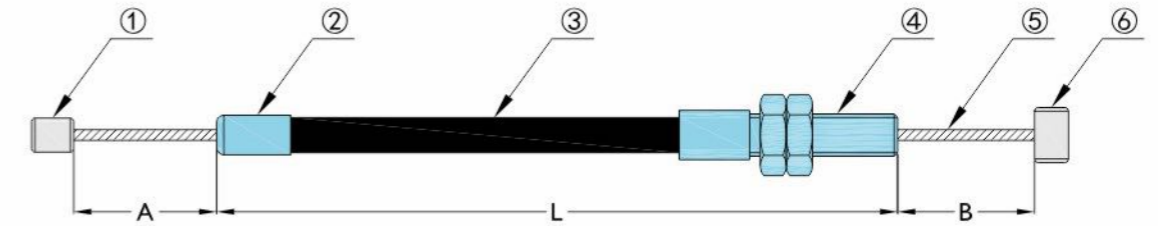

◆常用拉索结构主要四部分：钢丝绳（⑤），套管（③），钢丝绳末端配件（①和⑥），套管末端配件（②和④）。

◆Ordinary Structure include 4 parts: Wire rope ⑤, conduit ③, wire terminals(①&⑥), conduit fittings(②&④).

一般公差参考 Tolerance for reference(mm)

L		A+B	
范围 Travel	公差 Tolerance	范围 Travel	公差 Tolerance
< 500	±3	A+B ≤ 100	±1.5
500~1000	±4	100~200	±2
1000~2000	±5	200~500	±2.5
2000~3000	±8	500~1000	±3
> 3000	±0.003L	A+B > 1000	±0.005x(A+B)

◆如顾客有特殊要求，可以根据顾客要求定制。

◆If you have special requirement, we can produce according to your request.

产品选型说明 Product Selection

	①	②	③	④	⑤	⑥	L	A+B	最小破断强度 Min break load
页码 Page									
项目编号 Item NO.									
备注 Remarks									

◆顾客需提供我们①~⑥所需零件对应的页码和项目编号, L、A+B、破断强度等参数;

◆顾客也可以提供产品图纸, 按照图纸定制;

◆选择零件时注意和其它零件配合尺寸相对应;

◆此产品目录仅供参考, 以实际样品为准。

◆Customer need to give us specs of ①~⑥ and L & A+B & break load.

◆We can also produce according to customers' drawings.

◆Please note the assemble dimensions when you choose the accessories.

◆This product catalogue is for reference only, Products in kind prevail.