

- 钢丝绳末端配件---R形锻造端子
- Wire Rope End Fittings---Paddle Fittings

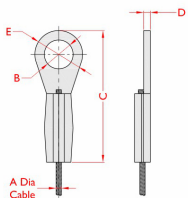

A For cable ϕ mm	$\phi B \pm 0.2$ mm	C Ref mm	D ± 0.15 mm	$\phi E \pm 0.3$ mm	材料 Material	项目编号 Item No.
<1.3	3.2	13.5	0.7	6	Stainless steel	113214
<1.3	3.6	13.7	0.7	6	Stainless steel	113614
<2.4	4.0	16.5	0.7	8	Stainless steel	114017
<1.8	4.2	22	0.9	8.6	Stainless steel	114222
<3.4	4.5	35	2	9	Zinc plated steel	114535
<2.3	5.0	29	1.5	10.8	Stainless steel	115029
<2.3	5.5	31	1.5	9.6	Zinc plated steel	115531
<4.0	6.3	36.5	2	12.9	Zinc plated steel	116337
<2.3	6.5	29.5	1.5 / 2.0	10.8	Zinc plated steel	116530
<2.3	7.0	29.5	1.5	10.8	Stainless steel	117030
<5.0	8.2	58.5	3	17	Zinc plated steel	118259
<1.5	8.7	26	1	15	Zinc plated steel	118726
<2.6	9.6	45	2.5	19	Zinc plated steel	119645

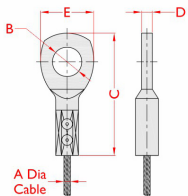

A For cable ϕ mm	$\phi B \pm 0.15$ mm	C Ref mm	D ± 0.2 mm	E Ref mm	材料 Material	项目编号 Item No.
1.5	6.3	26.5	2.0	11	Zinc plated steel	306427
1.5	7.0	26.5	2.0	11	Zinc plated steel	307027
2.5-4.0	8.5	46	4.1	20.3	Zinc plated steel	308546
2.5-4.0	11	46	4.1	20.3	Zinc plated steel	301146
5.0-8.0	12	56	6.1	26.7	Zinc plated steel	301256
2.5-4.0	13.0	46	4.1	20.3	Zinc plated steel	301346



- 钢丝绳末端配件---铝套
- Wire Rope End Fittings ---Aluminum Sleeves

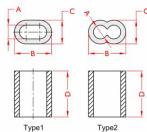

$\phi A \pm 0.2$ mm	B ± 0.2 mm	C ± 0.2 mm	D Ref mm	项目编号 Item No.	类型 Type
1.4	4	2.8	4.8	601440	Type1
1.4	4.8	3.1	7	601448	
2.1	6.3	4.3	7	602163	
2.1	6.3	4.3	8	602164	
2.8	7.7	5.3	9	602877	Type2
3.7	10.1	6.9	12	603710	
4.5	14	9.5	16	604514	
5.8	16.8	11	12	605817	
6.2	16.9	11	20.4	606217	
7.6	20.2	12.9	25	607620	

- 钢丝绳末端配件---钢丝绳打圈
- Wire Rope End Fittings ---Wire Rope Loop



ϕA For cable ϕ mm	ϕB Ref mm	C Ref mm	项目编号 Item No.
$0.5 \leq \phi < 1.0$	3.1	6	603160
$0.5 \leq \phi < 1.0$	3.4	8	603480
$1.2 \leq \phi < 1.8$	4.5	8.5	604585
$1.2 \leq \phi < 1.8$	4.5	9.5	604595
$1.5 \leq \phi < 2.5$	5.8	10.5	605811
$2.0 \leq \phi < 3.2$	7.5	14	607514
$3.0 \leq \phi < 4.0$	10.5	18	601118
$4.0 \leq \phi < 5.5$	12	15	601215
$4.5 \leq \phi < 6.0$	12	25	601225
$6.0 \leq \phi < 7.0$	15	26	601526

- ◆尺寸"D" "L"由顾客根据需求提供;
- ◆零件材质为: 铝 (自然色)。
- ◆The spec of "D" and "L" are according to the customer's requirement.
- ◆Materials: Aluminum (Natural color) .

- 钢丝绳末端配件---三角扣环 (不锈钢)
- Wire Rope End Fittings ---Thimble(stainless steel)

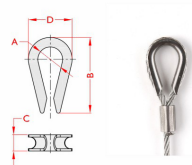

$\phi A \pm 0.5$ mm	B Ref mm	C mm	D Ref mm	项目编号 Item No.
7.2	20	<4.5	12	187220
10	23	<5.5	15.5	181023
13	32	<8.0	20.5	181332
20	49.5	<12.5	30.3	182050

■ 钢丝绳末端配件---螺杆

■ Wire Rope End Fittings---Screw Rod Fittings

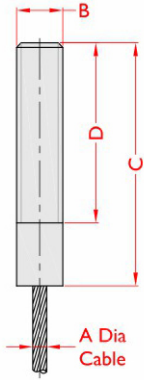

A For cable φmm	B mm	C Ref mm	D ± 1mm	最小破断强度 Min. Break Strength kgf	项目编号 Item No.
1.2	M4	11	7	65	244011
1.5	M4	10	5	100	240410
1.5	M5	40	30	100	240540
2.0	M5	50	38	150	240550
2.0/2.5	M6	60	39	150	240660
2.5/3.0	M6	36	20	220	240636
3.18	M6	52	32	250	240652
3.5	M6	58	40	320	240658
3.5	M8	55	40	320	240855

■ 钢丝绳末端配件---铆合端子

■ Wire Rope End Fittings---Riveting Fittings

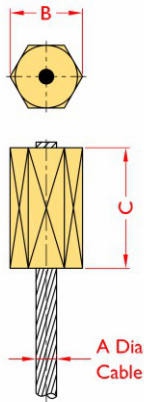

A For cable φmm	B ± 0.2 mm	C Ref mm	材料 Material	最小破断强度 Min. Break Strength kgf	项目编号 Item No.
0.8	3	4	Brass	15	233040
1.0	3.5	4	Brass	15	233540
1.8	5	5	Brass	30	235050
3.5	9	15	Steel	600	239015

■ 钢丝绳末端配件---铆合球头

■ Wire Rope End Fittings---Ball Fittings

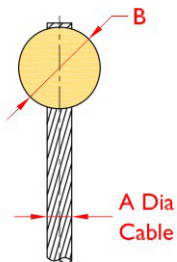

A For cable φmm	φB ± 0.2 mm	材料 Material	最小破断强度 Min. Break Strength kgf	项目编号 Item No.
1.2	4.1	Brass	20	231241
1.2	4.5	Brass	40	231245